



Waldram Park Road, Forest Hill, London



£1,600 PCM

- Two-bedroom flat
- Private Rear Garden
- Close to Station
- Council Tax Band: B
- First Floor
- Excellent location
- Available in May 2024
- EPC rating C



A charming two-bedroom, first floor flat nestled in the heart of Forest Hill, London. This bright and spacious property offers a perfect blend of modern comforts and urban convenience, ideal for those seeking a stylish yet tranquil living space.

The property benefits from recent extensive soundproofing and tenants have access to a small private garden at the rear of the building.

Conveniently located in Forest Hill, you'll find an array of amenities right at your doorstep. From trendy cafes and boutique shops to lush green spaces and excellent transport links, everything you need is within easy reach. Whether you're exploring the vibrant local scene or commuting to the city centre, this flat offers the perfect balance of convenience and tranquility.

Forest hill is a popular residential area, where urban living meets the tranquillity of nature! Nestled amidst lush greenery and charming architecture, Forest Hill offers a delightful blend



of city convenience and serene landscapes. Imagine strolling through tree-lined streets, discovering hidden gems in local shops, and enjoying picnics in beautiful parks like Horniman Gardens. With its vibrant community spirit, Forest Hill boasts a range of cultural attractions, from art galleries to independent cafes, perfect for indulging your creative side. With excellent transport links, including Overground services and multiple bus routes, reaching central London is also a breeze.

Whether you're seeking a peaceful retreat from the hustle and bustle or a vibrant neighbourhood full of life, Forest Hill has something for everyone. Don't miss the opportunity to make this stylish two-bedroom flat your new home in Forest Hill, where modern living meets timeless charm.

Council Tax band: B

EPC Rating: C

Deposit required: 5 weeks rent



Waldram Park, SE23 2PW

Approx Gross Internal Area = 52.41 sq m / 564 sq ft

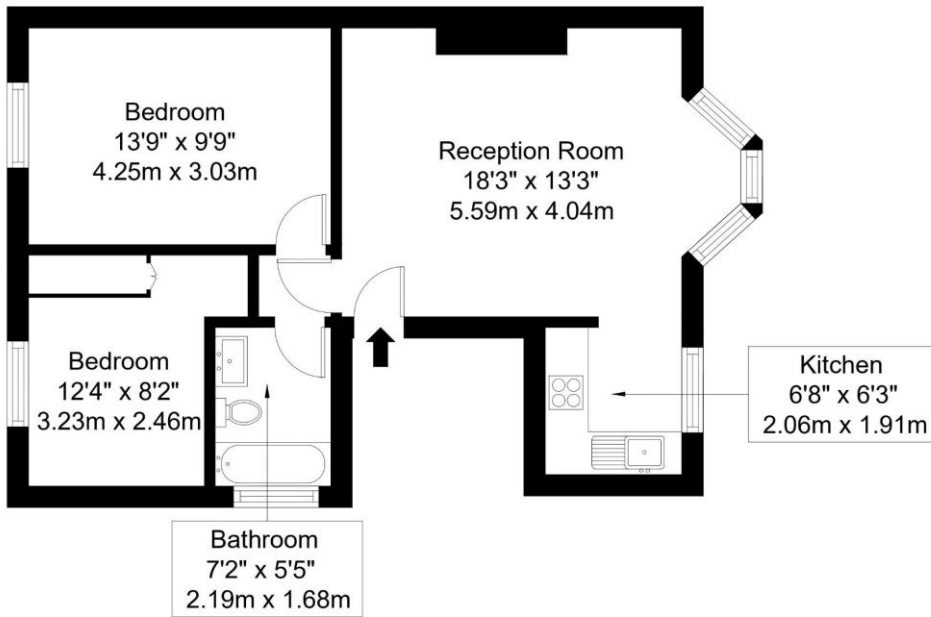

First Floor

Ref :

Copyright **BLEU
PLAN**

The Floor plan is not to scale and measurements and areas shown are approximate and therefore should be used for illustrative purposes only. The plan has been prepared in accordance with the RICS code of Measuring Practice and whilst we of part arty.



Daisy Property Services

02082999035

info@daisylets.uk