



Flat - Purpose Built

2 HAUNCH CLOSE, BIRMINGHAM, B13 0PZ

£950

FEATURES



2 Bedroom Flat - Purpose Built located in Birmingham

Property Local are proud to present this stunning flat is located in the heart of Kings Heath, one of the most sought-after areas in Birmingham, West Midlands. As soon as you step into the quiet complex, you'll be greeted by a sense of tranquility and charm. The flat boasts two spacious bedrooms, providing ample space for everyone. Both bedrooms are designed with comfort in mind, featuring a cozy setting the large windows that let in plenty of natural light. The main bedroom features an en-suite bathroom creating a convenient and luxury atmosphere. With a sleek and spacious design. The open lounge/kitchen space makes this flat even more special. As you enter this area, you'll be greeted by a sense of openness and warmth. The Kitchen comes equipped quality appliances, ample storage space, and a storage cupboard making it that much more practical. The lounge area is the perfect spot to relax and entertain guests. The open layout creates a seamless flow between the kitchen and living space, making it easy to socialize while preparing meals. Whether you're hosting a dinner party or enjoying a cozy night in, this space offers versatility and comfort. The flat also features large windows throughout, allowing natural light to flood every corner. This not only creates a bright and airy atmosphere but also offers picturesque views of the surrounding area. In terms of the natural surroundings, the complex has everything you need for a convenient and enjoyable lifestyle with plenty of parking space. Additionally, the complex is well-maintained and offers a sense of community, making it a great

Call us on

01215 790355

propertylocal@hotmail.com

Council Tax Band

B

Ground Floor

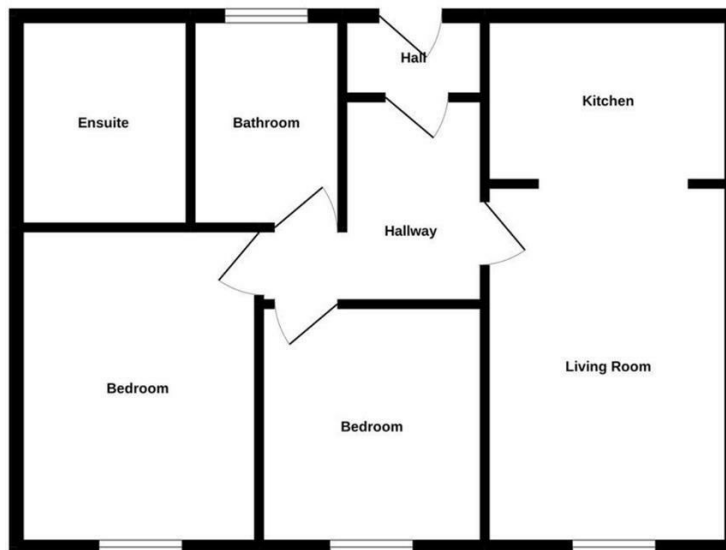

Measurements are approximate. Not to scale. Illustrative purposes only. Made with Metaplan ©2022

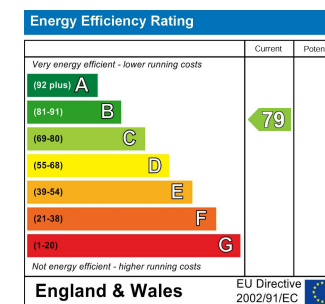

Agents Note: Whilst every care has been taken to prepare these particulars, they are for guidance purposes only. All measurements are approximate and are for general guidance purposes only and whilst every care has been taken to ensure their accuracy, they should not be relied upon and potential buyers are advised to recheck the measurements.

