



11 Millfield,
Cottenham, CB24 8RA

Guide price £375,000



11 Millfield, Cottenham , CB24 8RA

- Large garden
- 3/4 bedrooms
- Extended family house

An extended family house with 3/4 bedrooms, a large versatile living space and a long garden, in a quiet location within a popular village.

This family house has plenty of space, almost 1100 sq. ft, plus a large plot and planning permission to extend if needed (planning ref: 21/03402/HFUL).

There is a hallway, a refitted kitchen which is lovely and then a great open-plan family space that includes a living room with decorative gas fire, a dining room with roof light and doors to the garden. Beyond the living space, there is a fourth bedroom/family room and a luxuriously re-fitted bathroom.

Upstairs there is a landing and three bedrooms, two are doubles and one has extensive fitted storage.

The house has double glazing and gas central heating.

At the front of the house, there is a gravel driveway and a garage. A gate leads to the rear





garden which is large and mainly lawned, it offers good levels of privacy and backs onto fields.

Cottenham is a large, well-served village, Millfield is a no-through road, accessed off Rooks Street. The village provides schooling for all ages, excellent local shopping and a thriving community and recreation ground. The village is well-placed for those needing access to Cambridge Science Park, the A14, or the railway station at Waterbeach. All of which are just a few minutes away by car. SAT NAV: CB24 8SJ. What3words: ///safari.doses.crimson



Floor Plan

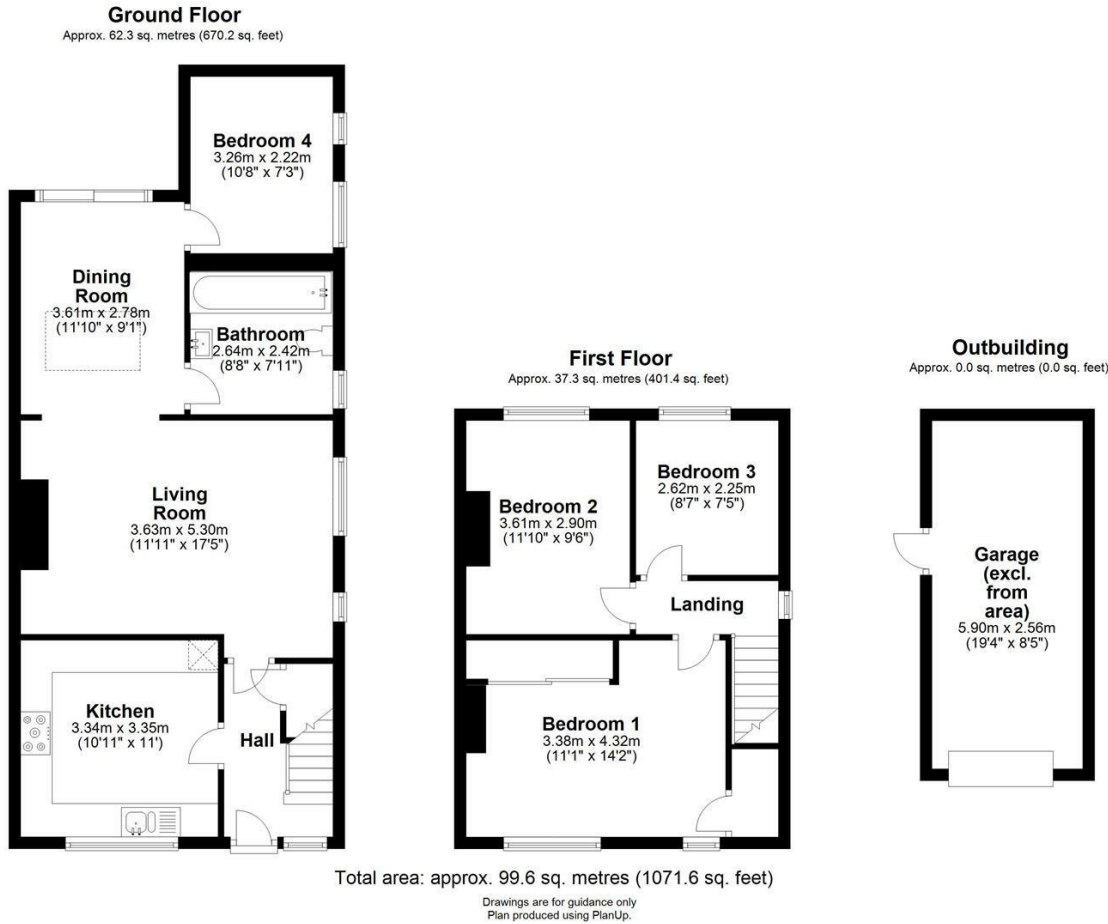

Area Map



Energy Efficiency Graph

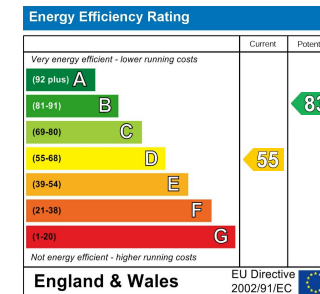

Viewing: Please contact our Gray & Toynbee - Waterbeach Office on 01223 949 444 if you wish to arrange a viewing appointment for this property or require further information.

Tenure: Freehold
Council tax band: C

These particulars, whilst believed to be accurate are set out as a general outline only for guidance and do not constitute any part of an offer or contract. Intending purchasers should not rely on them as statements of representation of fact, but must satisfy themselves by inspection or otherwise as to their accuracy. No person in this firm's employment has the authority to make or give any representation or warranty in respect of the property.

Cambridge Office: 154-156 Victoria Road, Cambridge, CB4 3DZ
Tel: 01223 439 888 Email: theteam@grayandtoynbee.com

Waterbeach Office: 17 High Street, Waterbeach, CB25 9JU
Tel: 01223 949 444 Email: waterbeach@grayandtoynbee.com

