



11 HAZEL GROVE

ROMFORD, RM6 5PX

£450,000
FREEHOLD

Hazel Grove, Little Heath, this delightful semi-detached residence represents a fantastic opportunity for families or investors. Boasting three generously sized bedrooms, it provides plenty of room for comfortable daily living. Two welcoming reception areas offer flexible space for both relaxing evenings and lively get-togethers, ensuring the home feels both practical and inviting.

Outside, you'll find a spacious garden perfect for activities or enjoying peaceful moments in the fresh air, complemented by convenient off-street parking. The broad plot affords excellent scope for extensions—subject to planning permission—so you can alter the layout to accommodate your lifestyle.

This property is chain-free and available immediately, making it an appealing choice for those eager to move into a sought-after neighbourhood without delay. Combining generous living space, untapped potential, and a prime location, this semi-detached gem in Hazel Grove is truly one-of-a-kind. Whether you envision creating your dream family home or investing in a property with solid

BELLS
ESTATE AGENT

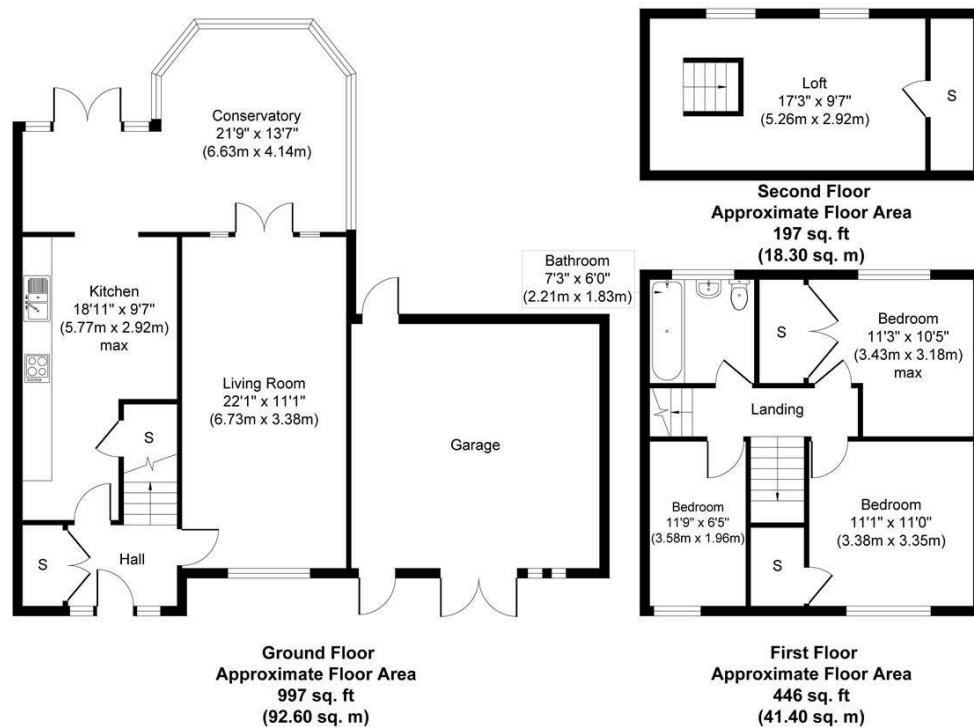

Whilst every attempt has been made to ensure the accuracy of the floor plan contained here, measurements of doors, windows, rooms and any other items are approximate and no responsibility is taken for any error, omission, or mis-statement. The measurements should not be relied upon for valuation, transaction and/or funding purposes. This plan is for illustrative purposes only and should be used as such by any prospective purchaser or tenant. The services, systems and appliances shown have not been tested and no guarantee as to their operability or efficiency can be given.
Copyright V360 Ltd 2025 | www.houseviz.com



Energy Efficiency Rating		
	Current	Potential
Very energy efficient - lower running costs		
(92 plus) A		
(81-91) B		
(69-80) C		
(55-68) D		
(39-54) E		
(21-38) F		
(1-20) G		
Not energy efficient - higher running costs		
England & Wales	EU Directive 2002/91/EC	

Agents Note: Whilst every care has been taken to prepare these particulars, they are for guidance purposes only. All measurements are approximate and are for general guidance purposes only and whilst every care has been taken to ensure their accuracy, they should not be relied upon and potential buyers/tenants are advised to recheck the measurements

Bells Estate Agent Limited
The Whitechapel Centre 85 Myrdle Street
London
Greater London
E1 1HL

02071128120
budruljamal@bellsestateagent.co.uk
<https://www.bellsestateagent.co.uk/default.aspx>

BELLS
ESTATE AGENT