



GARNET STREET

LONDON, E1W 3QY

£400,000
LEASEHOLD

****Chain Free**** A charming and spacious three-bedroom flat, located just a few minutes from Wapping Station. This lovely property boasts three generously sized bedrooms and a large living room, making it ideal for families or professionals seeking ample living space.

With excellent transport links, the flat is conveniently situated within walking distance of Wapping Station, offering easy access to the City. Additionally, the property is within easy reach of a wealth of local shops, bars, and restaurants in Wapping and nearby St Katharine Docks.

Don't miss out on this fantastic opportunity! Contact us today to arrange a viewing.

BELLS
ESTATE AGENT

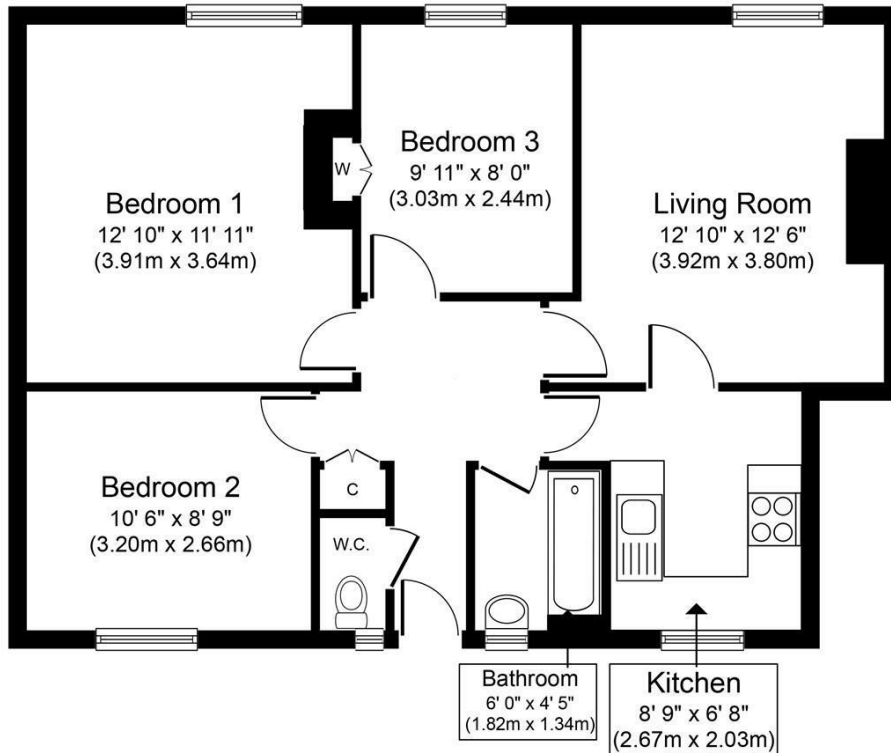

Approximate Floor Area
671 sq. ft.
(62.4 sq. m.)

Whilst every attempt has been made to ensure the accuracy of the floor plan contained here, measurements of doors, windows, rooms and any other items are approximate and no responsibility is taken for any error, omission, or mis-statement. The measurements should not be relied upon for valuation, transaction and/or funding purposes. This plan is for illustrative purposes only and should be used as such by any prospective purchaser or tenant. The services, systems and appliances shown have not been tested and no guarantee as to their operability or efficiency can be given.
Copyright V360 Ltd 2024 | www.houseviz.com



Energy Efficiency Rating		Current	Potential
Very energy efficient - lower running costs			
(92 plus) A			
(81-91) B			
(69-80) C			
(55-68) D			
(39-54) E			
(21-38) F			
(1-20) G			
Not energy efficient - higher running costs			
England & Wales		EU Directive 2002/91/EC	

Agents Note: Whilst every care has been taken to prepare these particulars, they are for guidance purposes only. All measurements are approximate and are for general guidance purposes only and whilst every care has been taken to ensure their accuracy, they should not be relied upon and potential buyers/tenants are advised to recheck the measurements

Bells Estate Agent Limited
The Whitechapel Centre 85 Myrdle
Street
London
Greater London
E1 1HL

02071128120
budruljamal@bellsstateagent.co.uk
<https://www.bellsstateagent.co.uk/default.aspx>

BELLS
ESTATE AGENT