



JOSHUA JAMES

ESTATE AGENTS

## Potton Road, Everton SG19 2LD

Asking Price £400,000

🛏️ 4 🚿 2 🛋️ 2

- Well Presented Chalet Style Property
- Separate Reception Rooms
- Master En-Suite & Family Bathroom
- Off Road Parking for a Number of Vehicles
- No Forward Chain
- Stunning Kitchen / Breakfast Room
- Four Bedrooms
- Rear Garden in Excess of 70ft
- Single Garage
- Popular Village Location



Well presented chalet style property located in the highly sought after village of Everton. Located opposite the children's play area & football field & within 100 yards of the village school. Offered for sale with no forward chain. Benefitting from a stunning comprehensively fitted kitchen / breakfast room, separate reception rooms, four bedrooms with en-suite shower to the master & a modern ground floor bathroom. Externally there is a delightful rear garden in excess of 70ft, off road parking for a number of vehicles & single garage.

Properties of this style & location very rarely come to the market so an early inspection is highly recommended.



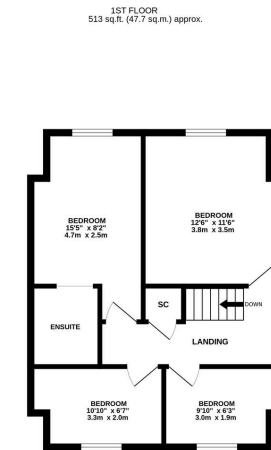
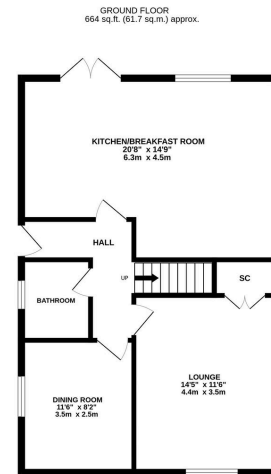

TOTAL FLOOR AREA: 1177 sq.ft. (109.4 sq.m.) approx.  
While every attempt has been made to ensure the accuracy of the description contained herein, measurements of floor, window, rooms and any other items are approximate and no responsibility is taken for any error, omission or misstatement. The plan is for guidance purposes only and should be used in conjunction with the prospective purchaser. The services, fixtures and appliances shown have been located and no guarantee is made as to their quantity or efficiency can be given.  
 Made with hampage 12/20

