

Wadnall Way, Knebworth, Hertfordshire, SG3 6DU

Guide Price £425,000

🛏 3 🚿 2 🚗 1



SCAN ME



- ****Brand New Link-Detached Home****
- Gas Central Heating
- Excellent Specification
- Landscaped Garden
- Bi-Folding Doors
- Driveway For 2 Cars
- Southerly Facing Garden
- Underfloor Heating (Ground Floor)
- Great Location
- Downstairs WC

The Hazels, 11 Wadnall Way, Knebworth, Hertfordshire
Approximate Gross Internal Area
80 Sq M/862 Sq Ft

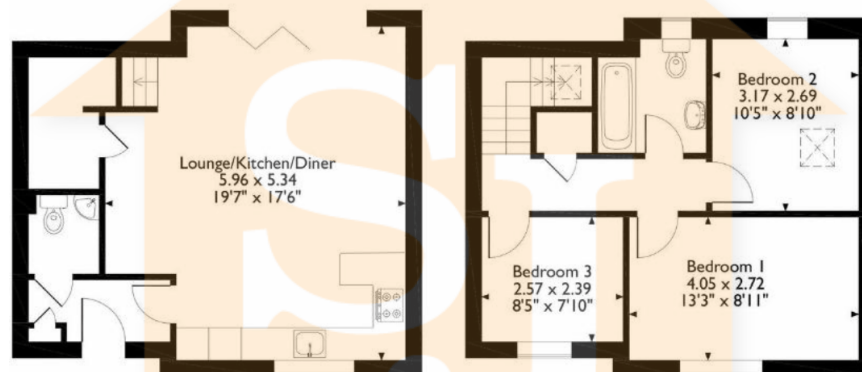

Ground Floor

First Floor

Please note that the location of doors, windows and other items are approximate and this floorplan is to be used for illustrative purposes only. Unauthorized reproduction is prohibited.

Spencer James Estates brings this 3 bedroom link-detached homes to the market in the sought after village of Knebworth. Built by JBK Estates in 2023, this home has off-street parking for two cars, is walking distance to Knebworth station and many fields and walks nearby.

SCAN ME

