

OFFERS OVER

£550,000

Raws Farm Steading
Strathaven, ML10 6PR

PROPERTY SUMMARY

****PLOT 2 RESERVED**** Enjoying what is arguably one of the best vantage points in Strathaven is this simply stunning, small and exclusive development of only two bespoke detached bungalows sympathetically designed to blend with their rural setting. Surrounded by the most beautiful South Lanarkshire countryside, upon an elevated position with incredible views, these attractive new build homes offer a rare opportunity for a discerning purchaser to acquire property of this calibre.

The spacious and versatile layout of apartments comprises; broad and welcoming reception hallway with curved feature wall adding to the aesthetic of the interior, two large storage cupboards, front facing family room/bedroom four, high-quality fitted kitchen with large island, integrated appliances, and walk-in pantry cupboard, spacious dining area, substantial formal lounge with striking vaulted ceiling and window formation flooding the room with light, and Aluclad doors leading to rear patio.

The bright and airy accommodation continues with a further three well-appointed double bedrooms. The luxurious master suite exudes elegance, with its own generous dressing room/walk-in closet, three-piece en-suite shower room,

4



3



2









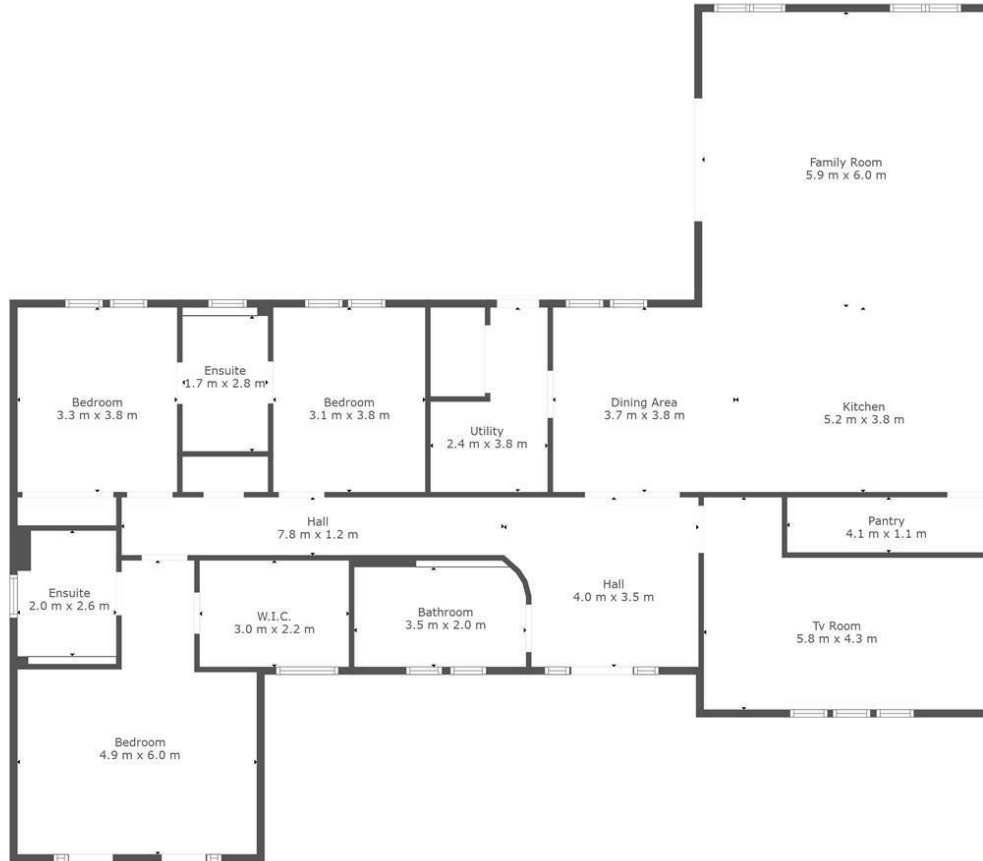

TOTAL: 203 m2
FLOOR 1: 203 m2
EXCLUDED AREAS: " " : 2 m2

This Floorplan Is Intended To Give An Indication Of The Layout Only.



cruive
ESTATE AGENTS

OFFICE ADDRESS
9 Townhead Street
Strathaven
ML10 6AB

OFFICE DETAILS
01357 510088
judithmcgill@cruive-
estateagents.co.uk

LOCAL AUTHORITY

South Lanarkshire

TENURE

Freehold

COUNCIL TAX BAND

VIEWINGS

By prior appointment only

Energy Efficiency Rating		
	Current	Potential
Very energy efficient - lower running costs		
(92 plus) A		
(81-91) B		
(69-80) C		
(55-68) D		
(39-54) E		
(21-38) F		
(1-20) G		
Not energy efficient - higher running costs		
Scotland	EU Directive 2002/91/EC 	

Agents Note: Whilst every care has been taken to prepare these particulars, they are for guidance purposes only. All measurements are approximate and are for general guidance purposes only and whilst every care has been taken to ensure their accuracy, they should not be relied upon and potential buyers/tenants are advised to recheck the measurements