



OFFERS OVER

£67,000

Green Street
Stonehouse, ML9 3LW

PROPERTY SUMMARY

Located within an attractive blonde sandstone building in the quiet Stonehouse address of Green Street is this spacious main door first floor traditional flat. With two double bedrooms, large attic room, and a Southwest facing private garden, this substantial flat would make an excellent first time buy or investment.

Accessed via a set of stone steps to the rear of the property, the accommodation comprises; entrance porch, reception hallway, sizeable front facing lounge, two generous bedrooms; master with fitted wardrobes, fitted kitchen, three-piece bathroom with over-bath shower, and large attic room accessed via ladder.

The property further benefits from gas central heating, double glazing, and well-maintained Southwest facing garden with slabbed area, and chipped patio.

2



1



1









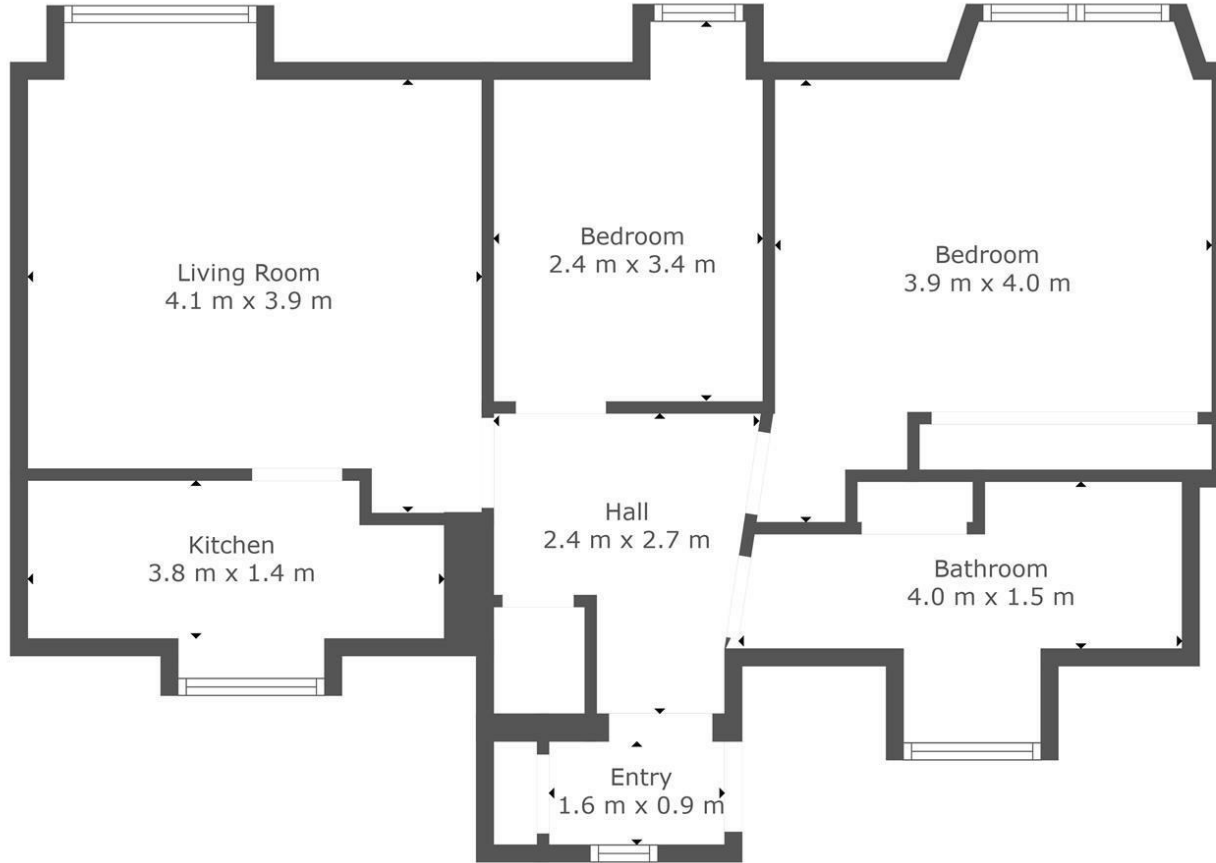

TOTAL: 59 m²
FLOOR 1: 59 m²
EXCLUDED AREAS: BAY WINDOW: 3 m²

This Floorplan Is Intended To Give An Indication Of The Layout Only.

LOCAL AUTHORITY

South Lanarkshire

TENURE

Freehold

COUNCIL TAX BAND

A

VIEWINGS

By prior appointment only

Energy Efficiency Rating		
	Current	Potential
Very energy efficient - lower running costs		
(92 plus) A		
(81-91) B		
(69-80) C		
(55-68) D		
(39-54) E		
(21-38) F		
(1-20) G		
Not energy efficient - higher running costs		
Scotland		
		EU Directive 2002/91/EC

Agents Note: Whilst every care has been taken to prepare these particulars, they are for guidance purposes only. All measurements are approximate and are for general guidance purposes only and whilst every care has been taken to ensure their accuracy, they should not be relied upon and potential buyers/tenants are advised to recheck the measurements



cruive
ESTATE AGENTS

OFFICE ADDRESS

9 Townhead Street
Strathaven
ML10 6AB

OFFICE DETAILS

01357 510088
judithmcgill@cruive-
estateagents.co.uk