



FIXED ASKING PRICE

£224,995

Queensgate
Strathaven, ML10 6GQ



Ground Floor Plan Layout Scale 1:100

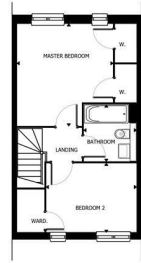

First Floor Plan Layout Scale 1:100

Room Dimensions

| | | | | | | |
|---------------------------|----------------------|---|-----------------|--------|---|--------|
| LIVING / DINING | 4.62m | X | 3.80m | 15' 1" | X | 12' 5" |
| KITCHEN | 2.55m | X | 2.23m | 8' 4" | X | 7' 3" |
| WC | 2.54m | X | 1.95m | 8' 3" | X | 6' 4" |
| MASTER BEDROOM | 3.67m | X | 3.97m | 12' 0" | X | 13' 0" |
| BEDROOM 2 | 3.48m | X | 2.68m | 11' 5" | X | 8' 9" |
| BATHROOM | 2.02m | X | 2.18m | 6' 7" | X | 7' 1" |
| GROSS INTERNAL FLOOR AREA | 75.00 m ² | | 807 Square Feet | | | |



Agents Note: Whilst every care has been taken to prepare these particulars, they are for guidance purposes only. All measurements are approximate and are for general guidance purposes only and whilst every care has been taken to ensure their accuracy, they should not be relied upon and potential buyers/tenants are advised to recheck the measurements.



OFFICE ADDRESS
 9 Townhead Street
 Strathaven
 ML10 6AB

OFFICE DETAILS
 01357 510088
 judithmcgill@cruive-estateagents.co.uk