



OFFERS OVER

£225,000

Manse Road
Stonehouse, ML9 3QP

PROPERTY SUMMARY

Immaculately maintained by the present owners, this substantial modern detached bungalow offers stylish and flexible family living. Situated on a large plot with fully enclosed, Southwest facing gardens and within easy reach of M74 this beautiful home is sure to impress.

The already generous accommodation has the potential to be extended to the upper floor as the neighbouring property has already done. Subject to planning this could offer a further two bedrooms and bathroom should a future owner require more space.

The beautifully presented accommodation comprises; broad and welcoming reception hallway, three well-appointed bedrooms; master with en-suite shower room and built-in storage, bedroom two also with fitted storage, modern three-piece family bathroom with over-bath shower and a stunning modern fitted kitchen open to living and dining areas with feature log burning stove and French doors opening onto the child/dog friendly garden and a raised decking area ideal for al fresco dining.

3



2



2









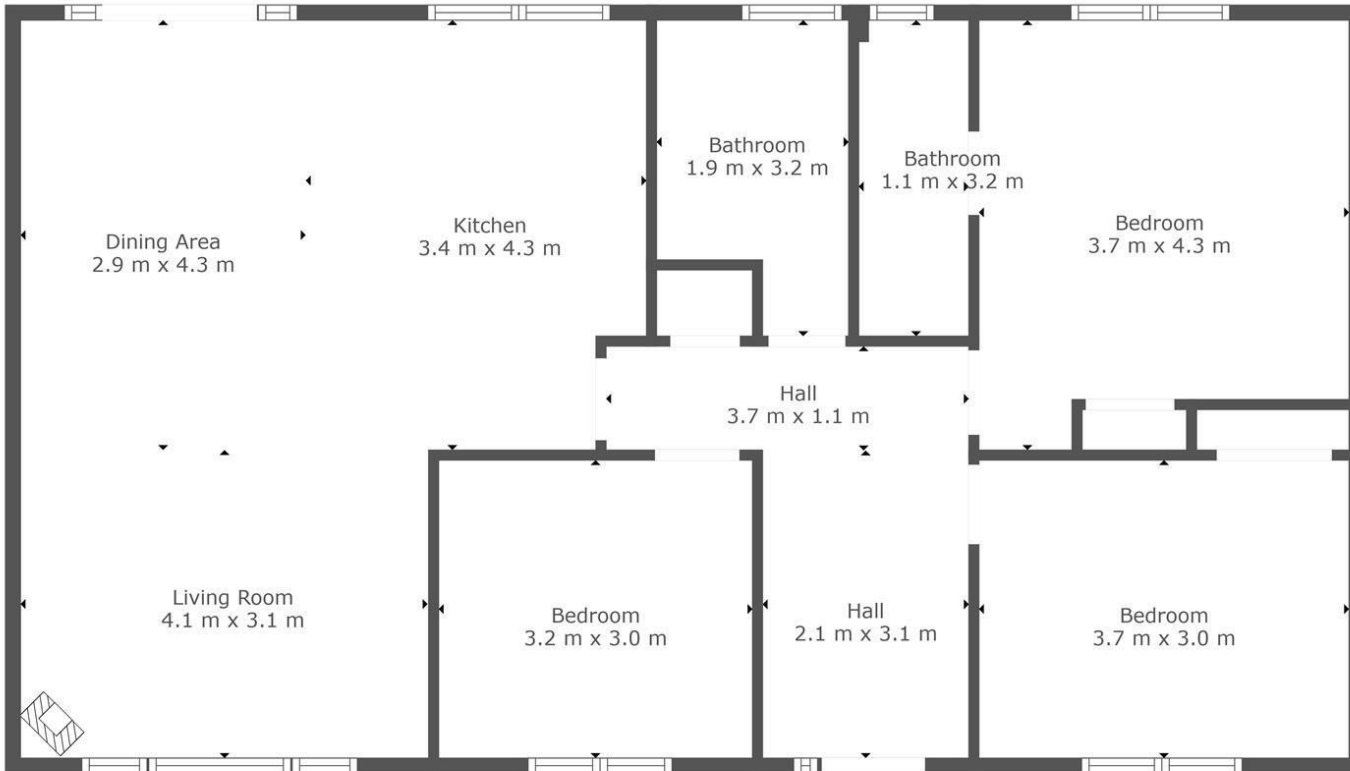

LOCAL AUTHORITY

South Lanarkshire

TENURE

Freehold

COUNCIL TAX BAND

E

VIEWINGS

By prior appointment only

Energy Efficiency Rating		
	Current	Potential
<i>Very energy efficient - lower running costs</i>		
(82 plus) A		
(81-81) B		
(69-80) C		69
(55-68) D	54	
(39-54) E		
(21-38) F		
(1-20) G		
<i>Not energy efficient - higher running costs</i>		
Scotland	EU Directive 2002/91/EC	

Agents Note: Whilst every care has been taken to prepare these particulars, they are for guidance purposes only. All measurements are approximate and are for general guidance purposes only and whilst every care has been taken to ensure their accuracy, they should not be relied upon and potential buyers/tenants are advised to recheck the measurements



TOTAL: 100 m2
FLOOR 1: 100 m2

This Floorplan Is Intended To Give An Indication Of The Layout Only.



OFFICE ADDRESS
9 Townhead Street
Strathaven
ML10 6AB

OFFICE DETAILS
01357 510088
judithmcgill@cruive-
estateagents.co.uk