



the agent



1 Hampton Manor Hampton Street, Lincoln, LN1 1BJ

Offers In The Region Of £355,000

- Spacious Modern Town House
- Four Double Bedrooms
- Off Street Parking for 1 Vehicle
- No Onward Chain
- West End Location
- Two Ensuites
- Enclosed Rear Garden
- Close to City Centre
- Large Open Plan Kitchen
- Bi Fold Doors

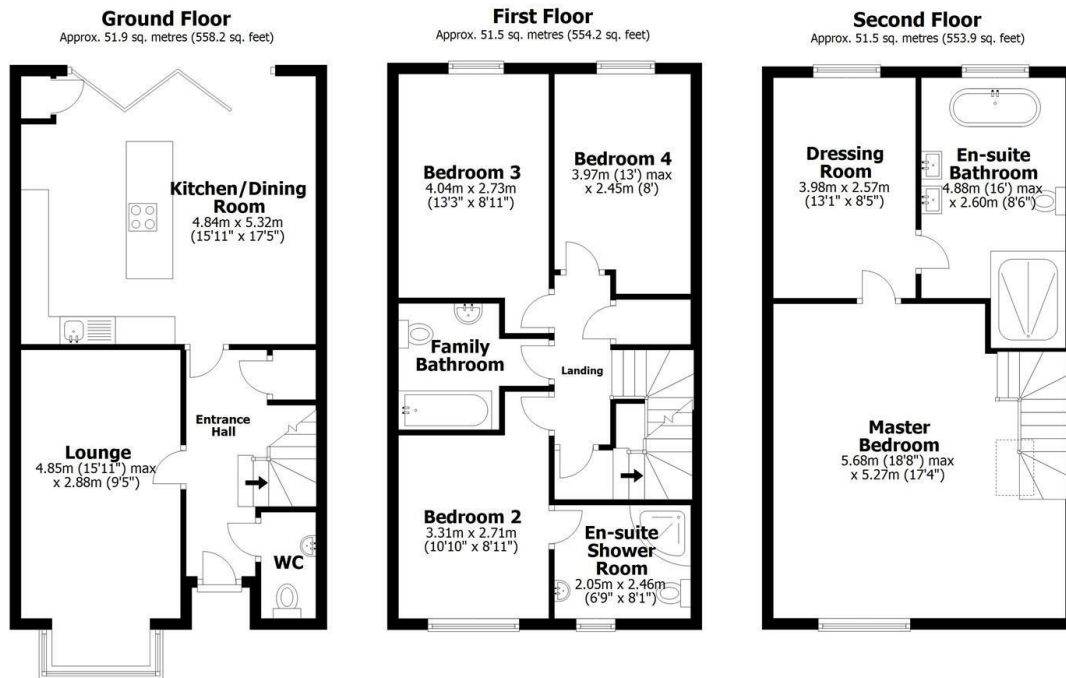

Total area: approx. 154.8 sq. metres (1666.3 sq. feet)

This plan is for layout guidance only. Not drawn to scale unless stated. Windows and door openings are approximate. Whilst every care is taken in the preparation of this plan, please check all dimensions, shapes and compass bearings before making any decisions reliant upon them. All interested parties must verify their accuracy independently.
Plan produced using PlanUp.

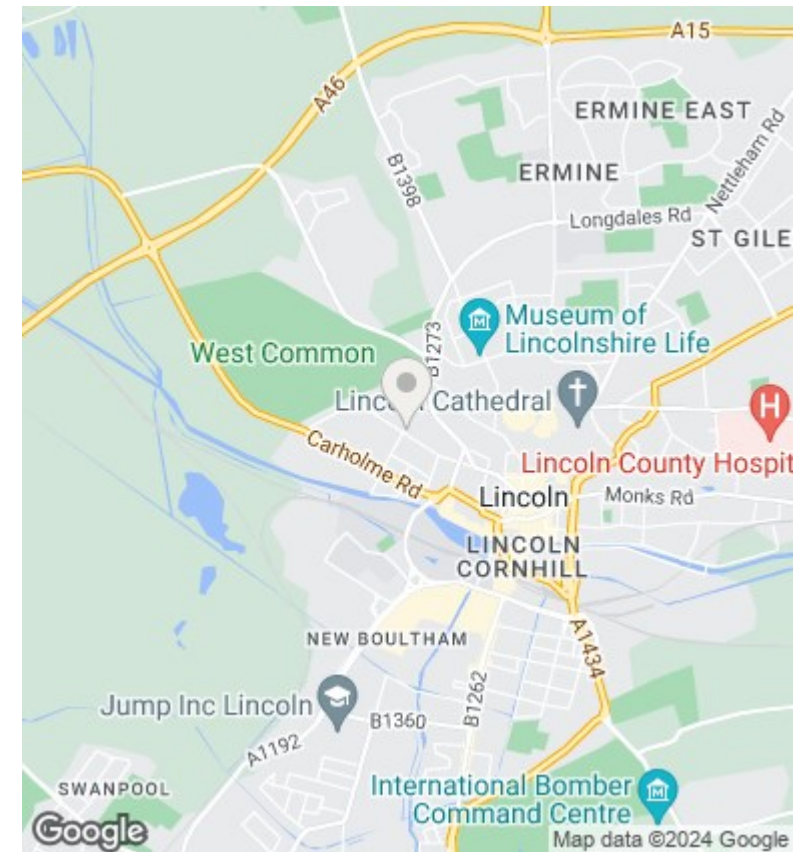

Directions

Viewings

Viewings by arrangement only. Call 03330904071 to make an appointment.

Council Tax Band

B

EPC Rating:

B

Energy Efficiency Rating		
	Current	Potential
Very energy efficient - lower running costs		
(92 plus) A		
(81-91) B	82	89
(69-80) C		
(55-68) D		
(39-54) E		
(21-38) F		
(1-20) G		
Not energy efficient - higher running costs		
England & Wales	EU Directive 2002/91/EC	