



THE
YORKSHIRE PROPERTY
AGENCY

Morton Carr Farm, Nunthorpe

Offers Over £1,750,000

🛏️ 8 🚗 2 🛋️ 3



- Unmodernised farm with huge potential
- Huge potential to create commercial opportunities with on-site family home.
- Numerous and substantial brick and steel construction outbuildings
- Proximity to the amenities of Nunthorpe, Middlesbrough, Stokesley etc
- The main house benefits from recent underpinning work
- Stunning 7/8 bedroom Edwardian farmhouse with semi-wrap-around garden
- Land to be negotiated separately
- Flexible accommodation and huge further potential to develop (STPP)
- Prime TS7 location
- Off-street parking for multiple cars



The Yorkshire Property Agency are delighted to introduce this fabulous unmodernised farm house with substantial outbuildings and surrounding land (land to be negotiated separately) located in a prime rural location on the periphery of Nunthorpe, TS7. This site offers huge potential to create commercial opportunities with an incredible on-site family home. The beautiful detached Edwardian farmhouse requires updating throughout and offers enormous living accommodation, flexible lateral space and huge proportions.

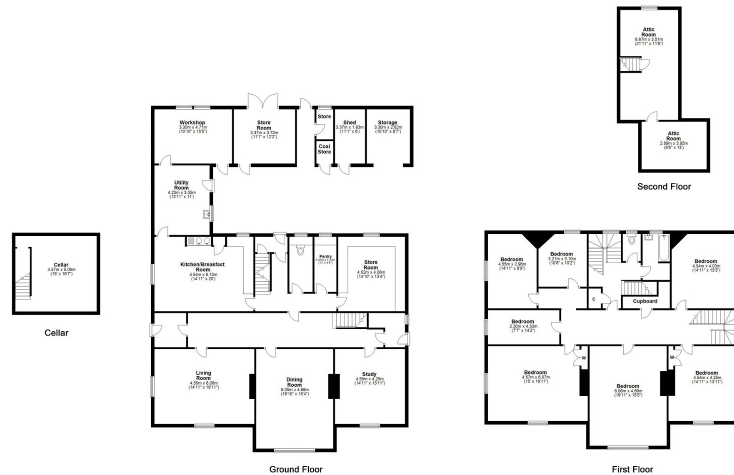

Whilst every attempt has been made to ensure the accuracy of the floorplans contained here, measurements of doors, windows, rooms and any other items are approximate and no responsibility is taken for any error, omission or mis-statement. This plan is not drawn to scale and is for illustrative purposes only & should be used as such by any prospective purchaser. Created by Vue3sixty Ltd

Energy Efficiency Rating		Current	Potential
Very energy efficient - lower running costs			
(92 plus)	A		
(81-91)	B		
(69-80)	C		
(55-68)	D		
(39-54)	E		45
(21-38)	F		
(1-20)	G	1	
Not energy efficient - higher running costs			
England & Wales		EU Directive 2002/91/EC	