

BRUNTON

RESIDENTIAL



CHURCH LANE, WOLSINGHAM, DL13 3

Offers Over £250,000

BRUNTON

RESIDENTIAL





BRUNTON

RESIDENTIAL



BRUNTON

RESIDENTIAL



Stylish & Immaculately Presented Stone Built Cottage, Situated within a Delightful Market Town & Boasting a Wonderful Lounge, Extended & Re-Fitted Kitchen/Dining Space with Bi-Folding Doors, Cellar/Basement, Two Double Bedrooms, Contemporary Re-Fitted Shower Room plus En-Suite Bathroom & Private Enclosed West Facing Rear Courtyard.

This beautiful, stone-built terraced home is perfectly placed within the desirable and historic market town of Wolsingham, County Durham.

The property itself, which was originally purchased by the current owner in 2021 and has since been sympathetically renovated, is ideally situated within Weardale, and is located near to the villages of Stanhope and Frosterley (which are located to the east), and Crook which is placed to the west.

Wolsingham provides a range of excellent amenities including several shops, cafes and public houses, a swimming pool, GP's surgery, and outstanding local schooling. Durham City Centre is also positioned only 25 minutes' drive away, with its shops, restaurants, and transport links, as well as the lovely market town of Barnard Castle.

BRUNTON

RESIDENTIAL



BRUNTON

RESIDENTIAL

The internal accommodation comprises: Entrance into lounge with engineered oak flooring, Inglenook fireplace and recent 'Chilli Penguin' woodburning stove and window with working shutter. A door from the rear of the lounge leads into a central lobby with stairs leading down to both the cellar and to the first floor. The cellar is very well presented with wood paneling, original stone flooring and window into the kitchen/diner.

The kitchen/diner has been extended and re-modelled, and now occupies the full width of the rear of the property. The kitchen area enjoys new cabinetry with stone, work-surfaces and integrated 'Neff' appliances. The dining area enjoys a roof-light and bi-folding doors that open out onto the private and enclosed rear courtyard, which is west facing.

The stairs then lead up to the first floor and give access, at the half landing, to a re-fitted shower room with three-piece suite. The top landing then gives access to two double bedrooms. Bedroom one is located to the front of the property and is generous in size, with a staircase leading up to a private, en-suite bathroom. Bedroom two is positioned to the rear and offers dual-aspect windows.

Externally, the property benefits from a wonderful, rear courtyard garden, which is west facing. This superb and tranquil space enjoys stone flagged tiled flooring, stone walled boundaries, raised planters with mature planting and timber pergola and offers an ideal space to enjoy the evening sun or to entertain outdoors.

Well presented, both internally and externally, this beautiful stone-built cottage simply demands an early inspection and viewings are strongly advised.



BRUNTON

RESIDENTIAL

TENURE : Freehold

LOCAL AUTHORITY : Durham County Council

COUNCIL TAX BAND :

EPC RATING : D

SERVICES :

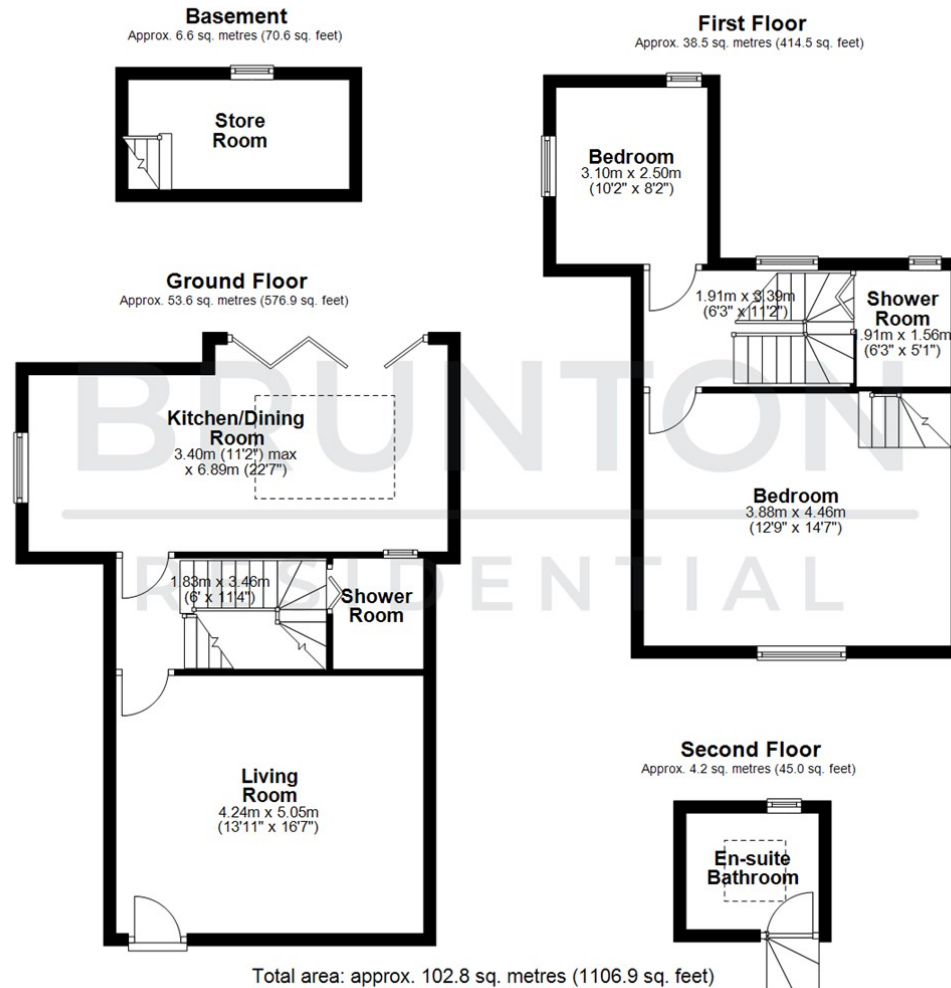

All measurements are approximate and are for illustration only.
Plan produced using PlanUp.



Energy Efficiency Rating		Current	Potential
Very energy efficient - lower running costs			
(92 plus) A			86
(81-91) B			
(69-80) C			
(55-68) D		55	
(39-54) E			
(21-38) F			
(1-20) G			
Not energy efficient - higher running costs			
England & Wales		EU Directive 2002/91/EC	

Environmental Impact (CO ₂) Rating		Current	Potential
Very environmentally friendly - lower CO ₂ emissions			
(92 plus) A			
(81-91) B			
(69-80) C			
(55-68) D			
(39-54) E			
(21-38) F			
(1-20) G			
Not environmentally friendly - higher CO ₂ emissions			
England & Wales		EU Directive 2002/91/EC	