

BRUNTON

RESIDENTIAL



WOODLANDS, HEXHAM, NE46

Asking Price £475,000

BRUNTON

RESIDENTIAL





BRUNTON

RESIDENTIAL



BRUNTON

RESIDENTIAL



STUNNING PERIOD HOME – GREAT LOCATION

Brunton Residential are delighted to offer for sale this stunning terraced home with an abundance of character. Woodlands is located in the east end of Hexham, a thriving market town with ample amenities and transport links. This property boasts some stunning features throughout.

BRUNTON

RESIDENTIAL



BRUNTON

RESIDENTIAL

Accommodation comprises an entrance porch into a hallway with the lounge and dining room to the left, and the kitchen to the rear of the property overlooking the garden. The spacious and light lounge provides a huge, elevated bay window to the front of the property alongside a gorgeous fireplace. In the lounge and throughout the property, you find high ceiling, ceiling roses, coving and deep skirting boards which add to the charm of this very grand property. The dining room allows access to the garden via the French doors with side panels which makes this south facing room very bright. The unique kitchen provides the ideal space for hosting as it provides extra space for a dining area as well as having plenty storage within the exceptional wall and floor units and a fantastic, new range oven. From here you access the handy utility room and downstairs WC as well as the rear garden.

To the first floor, you have a landing area with access to a bedroom, the bathroom and the separate WC. There is a further landing area with access to the other 3 bedrooms. The master bedroom is a great room that has a large bay window to the front and another magnificent fireplace adding to the elegance of the room.

Externally, there is a garden to the front of the property mainly laid to lawn, and to the rear the garden is a combination of lawn and paving. The garage, within the rear yard, provides convenient parking and storage solutions, adding to the practicality of this lovely home.

This delightful home is located on the desirable Woodlands, Hexham. Woodlands, which is just off the Corbridge road, is perfectly situated only a short walk from the centre of Hexham with its wonderful array of shops, cafes and amenities and the local market. The property is also positioned close to outstanding local schooling, of which there is a wide selection of schools including The Sele First School, which provides exceptional education from 3-9 years, and the well-regarded Hexham Middle School and Queen Elizabeth High School. In addition, Mowden Hall Preparatory School is also located a short drive away.



BRUNTON

RESIDENTIAL

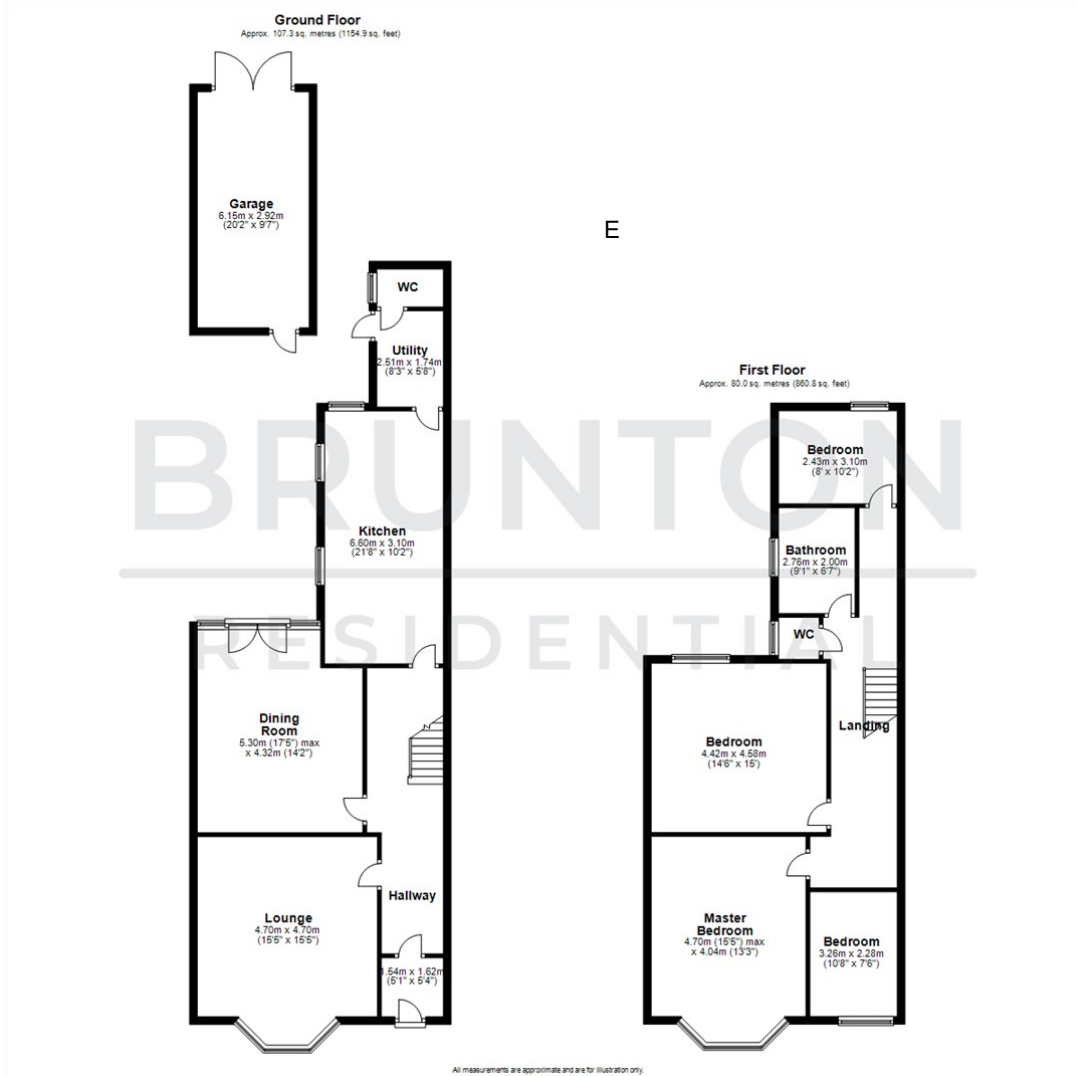

All measurements are approximate and are for illustration only.
Plan produced using PlanUp.

TENURE : Freehold

LOCAL AUTHORITY : Northumberland
County Council

COUNCIL TAX BAND : E

EPC RATING : E

SERVICES :

