



SPURWAY DAYS-POTTLES LANE EXETER

£550 Per

Lock-up storage/workshop unit
Lighting and power
Own WC
Parking
Available now
Suitable for various uses.



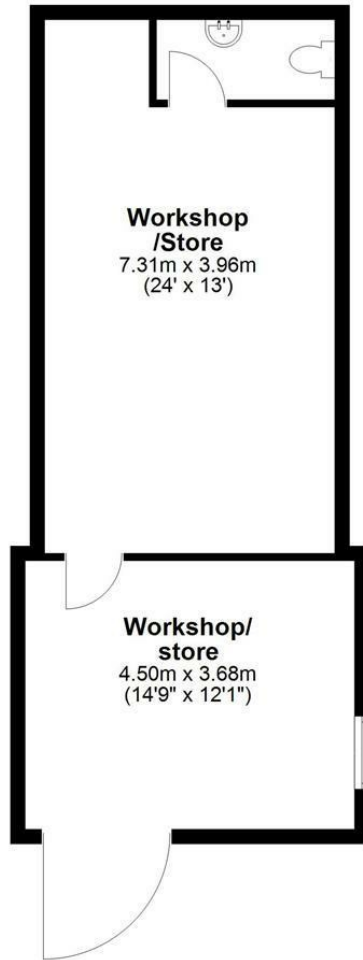

Total area: approx. 46.0 sq. metres
(494.6 sq. feet)

Unit 4 Spurway Farm, Exminster



Energy Efficiency Rating		
	Current	Potential
Very energy efficient - lower running costs		
(92 plus) A		
(81-91) B		
(69-80) C		
(55-68) D		
(39-54) E	42	
(21-38) F		
(1-20) G		
Not energy efficient - higher running costs		
England & Wales		EU Directive 2002/91/EC

Agents Note: Whilst every care has been taken to prepare these particulars, they are for guidance purposes only. All measurements are approximate and are for general guidance purposes only and whilst every care has been taken to ensure their accuracy, they should not be relied upon and potential buyers/tenants are advised to recheck the measurements