



## SPURWAY DAYS-POTTLES LANE

EXETER, EX6 8AZ

£575 PER MONTH

Lock-up storage/workshop unit  
Lighting and power  
Own WC  
Parking  
Available now  
Suitable for various uses.

**weekes**  
& partners  
estate agents

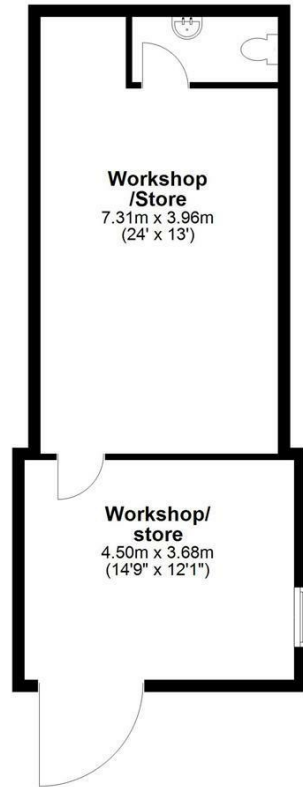

Total area: approx. 46.0 sq. metres  
(494.6 sq. feet)  
**Unit 4 Spurway Farm, Exminster**



Energy Efficiency Rating		
	Current	Potential
Very energy efficient - lower running costs		
(92 plus) <b>A</b>		
(81-91) <b>B</b>		
(69-80) <b>C</b>		
(55-68) <b>D</b>		
(39-54) <b>E</b>	<b>42</b>	
(21-38) <b>F</b>		
(1-20) <b>G</b>		
Not energy efficient - higher running costs		
<b>England &amp; Wales</b>	EU Directive 2002/91/EC	

Agents Note: Whilst every care has been taken to prepare these particulars, they are for guidance purposes only. All measurements are approximate and are for general guidance purposes only and whilst every care has been taken to ensure their accuracy, they should not be relied upon and potential buyers/tenants are advised to recheck the measurements

LCO Management  
Broadwalk House Southernhay West  
Exeter  
Devon  
EX1 1TS

01392 343200  
enquiries@lcomanagement.com

**weekes**  
& partners  
estate agents