



DAYS-POTTLES LANE EXETER

£550 Per

Lock-up storage/workshop unit with lighting and power.

Own WC and parking, available from now.

Suitable for various uses, however, please note that it is not suitable for the motor trade.



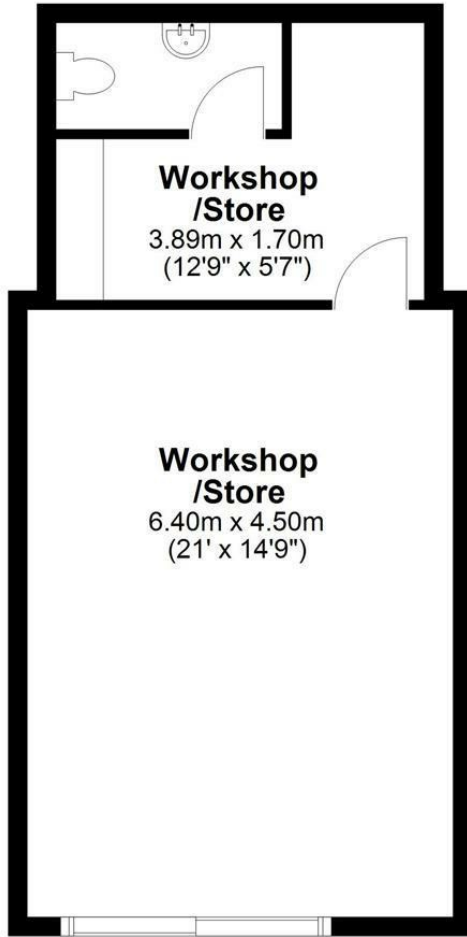

Total area: approx. 40.6 sq. metres
(436.8 sq. feet)

Unit 6, Spurway Farm, Exminster



| Energy Efficiency Rating | | Current | Potential |
|---|--|-------------------------|-----------|
| Very energy efficient - lower running costs | | | |
| (92 plus) A | | | |
| (81-91) B | | | |
| (69-80) C | | | |
| (55-68) D | | | |
| (39-54) E | | | |
| (21-38) F | | | |
| (1-20) G | | | |
| Not energy efficient - higher running costs | | | |
| England & Wales | | EU Directive 2002/91/EC | |

Agents Note: Whilst every care has been taken to prepare these particulars, they are for guidance purposes only. All measurements are approximate and are for general guidance purposes only and whilst every care has been taken to ensure their accuracy, they should not be relied upon and potential buyers/tenants are advised to recheck the measurements