



Woodside Avenue
Boothville, Northampton

oriordanbond
SALES & LETTINGS



GROUND FLOOR
833 sq.ft. (77.4 sq.m.) approx.

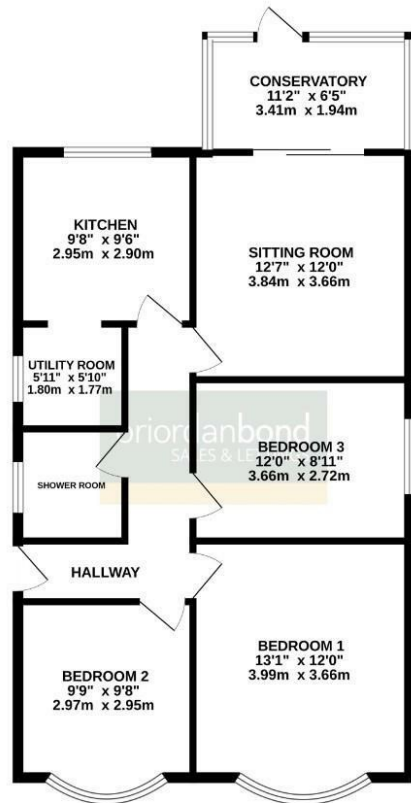

TOTAL FLOOR AREA : 833 sq.ft. (77.4 sq.m.) approx.

Whilst every attempt has been made to ensure the accuracy of the floorplan contained here, measurements of doors, windows, rooms and any other items are approximate and no responsibility is taken for any error, omission or mis-statement. This plan is for illustrative purposes only and should be used as such by any prospective purchaser. The services, systems and appliances shown have not been tested and no guarantee as to their operability or efficiency can be given. Made with floorplan.co.uk

Woodside Avenue

Boothville

NN3 6JL

PRICE £295,000

A spacious three bedroom detached bungalow situated on a generous plot on the edge of the popular location of Boothville. The property provides good access to local amenities as well as Weston Favell Shopping Centre.

The accommodation comprises entrance hall, sitting/dining room, conservatory, re-fitted kitchen and utility room, three double bedrooms and a re-fitted shower room. Outside is a good size enclosed rear garden and a driveway to the front providing off road parking. Further benefits include uPVC double glazing and gas radiator heating. (B/833/M)

Additional information

- Council Tax Band: D
- Energy Efficiency Rating: D

Viewing

Viewing strictly by appointment – details below

Disclaimer

O'Riordan Bond Estate Agents Limited has not tested apparatus, equipment, fittings or services and so cannot verify they are in working order. The buyer is advised to obtain verification from their solicitor or surveyor.

O'Riordan Bond Abington East Sales
01604 639007

abingtoneast@oriordanbond.co.uk

