

THOMAS  
MERRIFIELD

SALES LETTINGS



## 24 Farmington Drive, Witney, OX28 5GJ

£1,150 PCM - 13th June 2025.

- One bedrooms
- Small garden
- Council Tax B
- Unfurnished
- Off street parking
- Gas CH
- EPC rating D

Holyfield House 1 Walton Well Road, Oxford, OX2 6ED  
01865 515900

info@tmlettings.co.uk  
<https://www.tmlettings.co.uk>

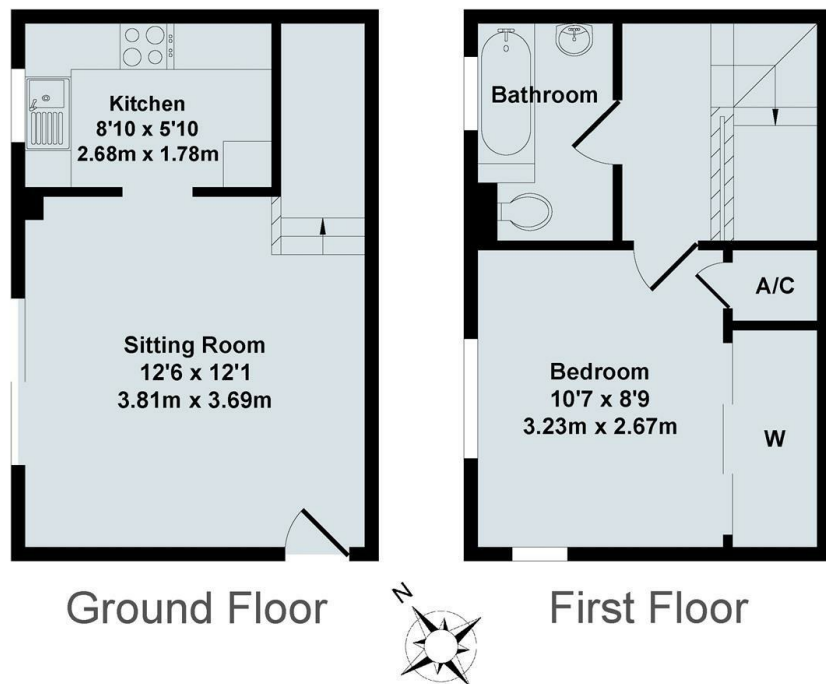

Total Approx. Floor Area 452 Sq.Ft. (42.0 Sq.M.)

All items illustrated on this plan are included in the "Total Approx Floor Area"

## Directions

## Viewings

Viewings by arrangement only. Call 01865 515900 to make an appointment.

## Council Tax Band

B

## EPC Rating:

D

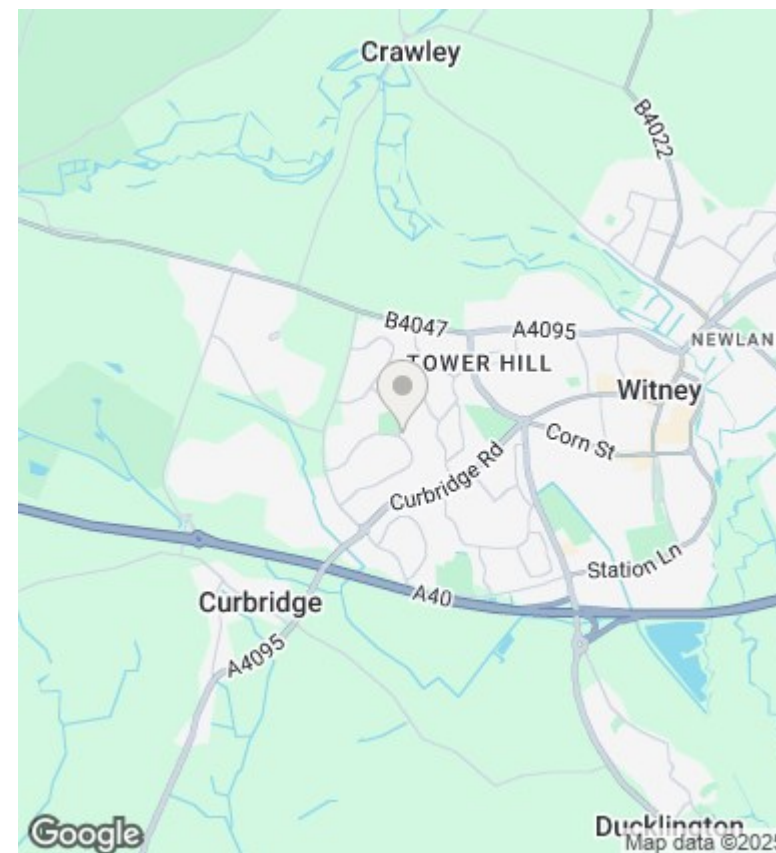

Energy Efficiency Rating		
	Current	Potential
Very energy efficient - lower running costs		
(92-plus) <b>A</b>		<b>88</b>
(81-91) <b>B</b>		
(69-80) <b>C</b>	<b>67</b>	
(55-68) <b>D</b>		
(39-54) <b>E</b>		
(21-38) <b>F</b>		
(1-20) <b>G</b>		
Not energy efficient - higher running costs		
England & Wales		EU Directive 2002/91/EC