



Begonia Close, Chelmsford

Guide Price £450,000



Begonia Close

Chelmsford

A well presented three bedroom link-detached family home including off street driveway parking, garage and a particularly generous sized garden- all ideally positioned within sought-after Springfield, providing easy access in to Chelmsford City Centre
Council Tax band: D

Tenure: Freehold

EPC Rating: C

- Spacious open/plan reception/dining room
- Three bedroom link-detached house
- Frequent buses in to Chelmsford City Centre
- Generous sized garden
- Sought-after location
- Close to well regarded schools
- Downstairs cloakroom
- Separate well-equipped kitchen
- Easy access to A12 and beyond









Ground Floor

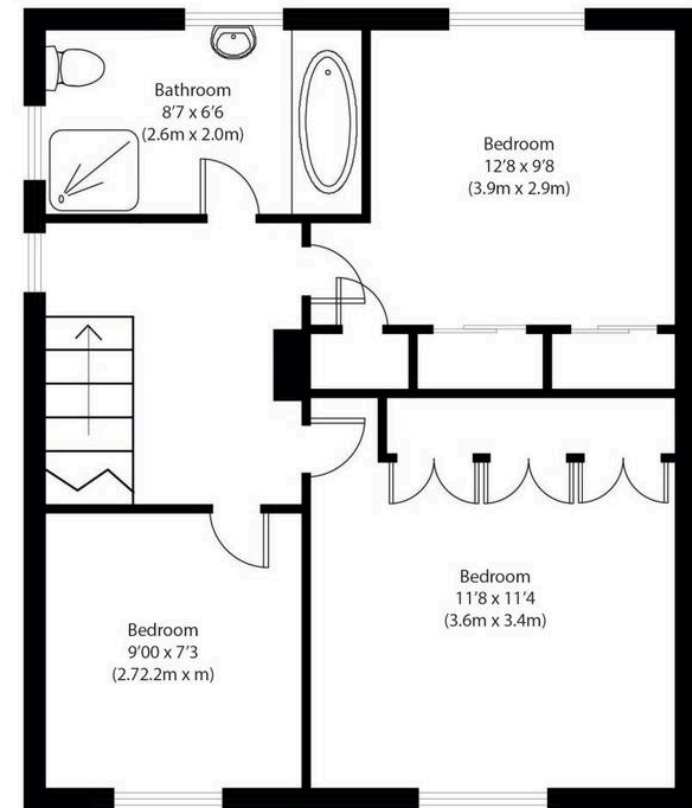

First Floor



Approximate Gross Internal Area
1065 sq ft (Including Garage) (99 sq m)

Disclaimer: Floorplan measurements are approximate and are for illustrative purposes only. While we do not doubt the floor plan accuracy and completeness, you or your advisors should conduct a careful, independent investigation of the property in respect of monetary valuation. copyright www.photohausgroup.co.uk



Nested Chelmsford

12-18 Theobalds Road, London - WC1X 8PL

01245 970045 • jack.gundry@nested.com • nested.com/chelmsford