

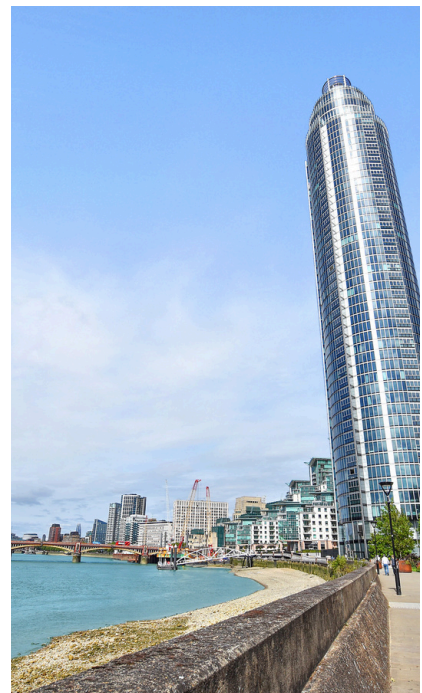

nested
prime

The Modern Estate Agent

1 St. George's Wharf, Vauxhall, London SW8



Luxurious living awaits the lucky new residents of this sleek and stylish river-view apartment. Set high on the sixth floor within prestigious The Tower, spectacular views are on show, paired perfectly with high-end finishes and designer features.



3 Bedrooms



2 Bathrooms



£2,225,000



Lonnee Hamilton
Partner, Nestled Prime
07535 604111 | 020 3886 2810
lonnee.hamilton@nested.com
www.nested.com



This stunning riverfront tower is located on the east side of Nine Elms and is the crown jewel of the St George Wharf development. Whether you love to entertain, or simply relax and take in the views, the open-plan living area is beautifully appointed to ensure absolute comfort. Floor-to-ceiling windows throughout provide fantastic river views.

The lucky new residents of this sleek and modern apartment will enjoy access to a host of amenities including an infinity-edge pool, a spa and fitness centre, 24-hour concierge and a car park.

The Tower, St. George's Wharf, SW8

Approximate Area = 1387 sq ft / 128.9 sq m
Including Limited Use Area (2.4 sq m / 26 sq ft)

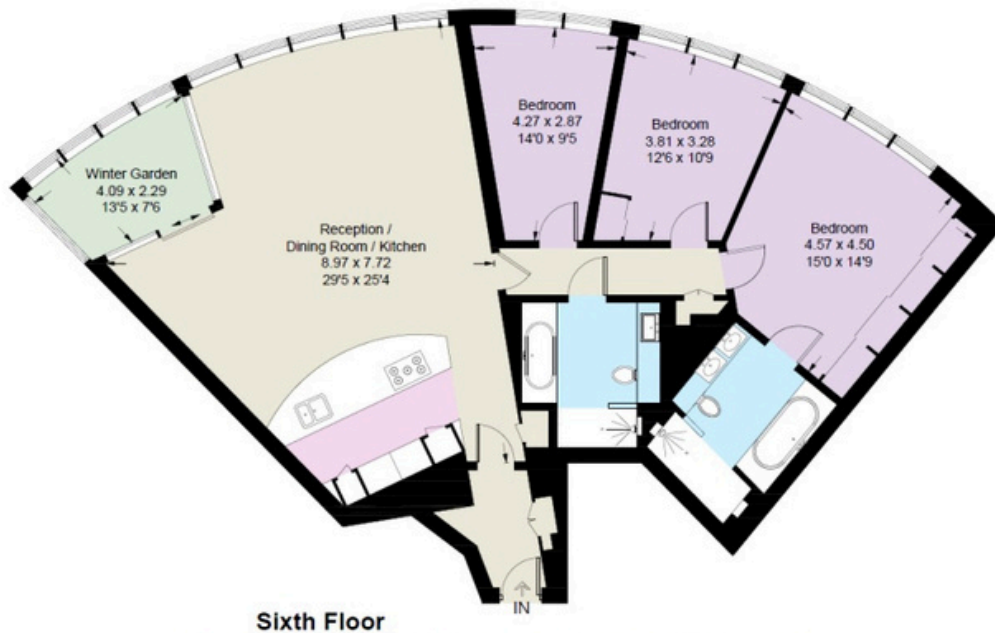

This plan is for layout guidance only. Not drawn to scale unless stated. Windows and door openings are approximate. Whilst every care is taken in the preparation of this plan, please check all dimensions, shapes and compass bearings before making any decisions reliant upon them. (ID601406)

Contact me to view



Lonnee Hamilton
Partner, Nestled Prime
07535 604111 | 020 3886 2810
lonnee.hamilton@nested.com
www.nested.com