

TO LET - OFFICE

---

# 71 FENCHURCH STREET

EC3M 4BS



## Key Highlights

- 4,732 to 90,712 sq ft
- Enhanced floor to ceiling heights
- Chilled beam air conditioning
- Reception cafe
- Grade A office accommodation
- Cycle spaces, showers and lockers
- Raised floors
- Superb natural light and City skyline view

---

SAVILLS City  
15 Finsbury Circus  
London EC2M 7EB  
**020 7499 8644**  
[savills.co.uk](http://savills.co.uk)



## Location

The building can be accessed via a re-landscaped private courtyard to the south of Fenchurch Street, the building is adjacent to Fenchurch Street mainline station and a few minutes walk from Lloyds. In addition to Fenchurch Street, numerous other transport hubs are within a short walk; Tower Hill (Docklands Light Railway, District and Circle lines), Aldgate (Circle, Metropolitan and Hammersmith & City lines) and Liverpool Street (mainline, Central, Circle, Metropolitan and Hammersmith & City lines).

## Description

The common parts of the building have undergone an extensive refurbishment including a re-landscaped courtyard with additional seating, a remodelled reception area and all the available floors being refurbished to a Category A specification.

## Accommodation

The accommodation comprises of the following

Name	sq ft	sq m	Tenure	Availability
11th	4,732	439.62	To Let	Available
10th	4,732	439.62	To Let	Available
7th	11,198	1,040.33	To Let	Available
6th	11,185	1,039.12	To Let	Available
4th	20,942	1,945.58	To Let	Available
1st	21,610	2,007.63	To Let	Available
Lower Ground	16,313	1,515.53	To Let	Available
<b>Total</b>	<b>90,712</b>	<b>8,427.43</b>		

## Specification

Grade A office accommodation  
Chilled beam air conditioning  
Enhanced raised floors  
Superb natural light and City skyline views  
Cycle spaces, showers and lockers  
Reception café  
Potential for self-contained entrance off Lloyd's Avenue  
EPC – C (68)

## Terms

Terms upon application

## Viewings

Strictly by arrangement

## Contact

**Josh Lamb**

07976 988 486

jlamb@savills.com

**Artie Taylor**

07866 203 403

artie.taylor@savills.com

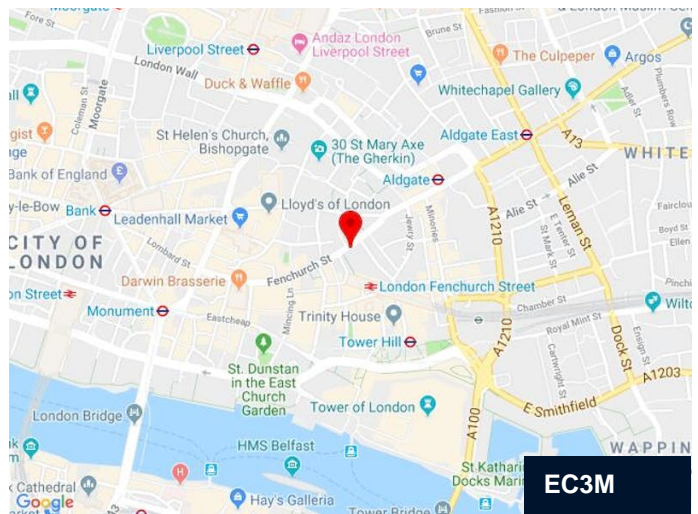
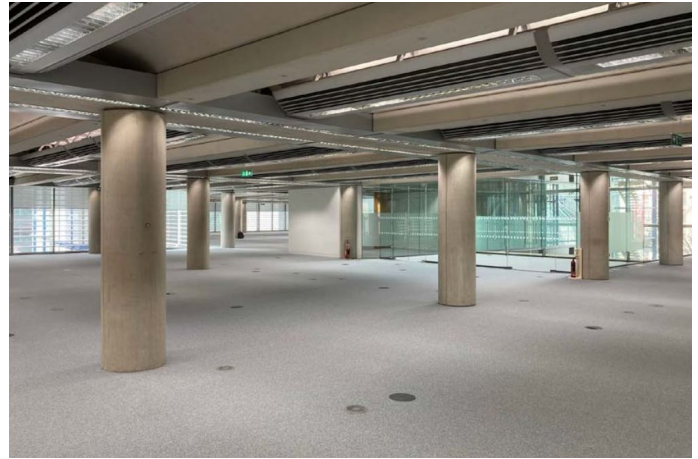
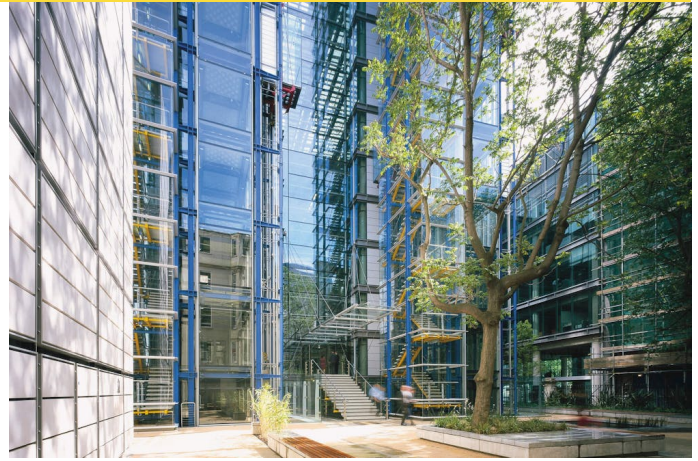

EC3M

### IMPORTANT NOTICE

Savills, their clients and any joint agents give notice that: 1. They are not authorised to make or give any representations or warranties in relation to the property either here or elsewhere, either on their own behalf or on behalf of their client or otherwise. They assume no responsibility for any statement that may be made in these particulars. These particulars do not form part of any offer or contract and must not be relied upon as statements or representations of fact. 2. Any areas, measurements or distances are approximate. The text, photographs and plans are for guidance only and are not necessarily comprehensive. It should not be assumed that the property has all necessary planning, building regulation or other consents and Savills have not tested any services, equipment or facilities. Purchasers must satisfy themselves by inspection or otherwise. Generated by AgentsInsight / Generated on 13/06/2024

savills