

TO LET - OFFICE

---

# 95 GRESHAM STREET

EC2V 7AB



## Key Highlights

- 13,413 sq ft
- Newly refurbished manned reception
- Semi-exposed Services
- Bicycle and shower facilities
- New CAT A Floor
- LED Lighting
- Atrium
- EPC: B

---

SAVILLS City  
15 Finsbury Circus  
London EC2M 7EB  
**020 7499 8644**  
[savills.co.uk](https://www.savills.co.uk)



## Location

Located within the core of the City and just a short walk from Bank, Liverpool Street, and Moorgate stations.

## Description

95 Gresham Street is a prominent building positioned on the north side of Gresham Street, within the heart of the City of London. It is moments from the Bank of England and the internationally renowned restaurant, bar and hotel, The Ned.

The 4th floor is available in a new contemporary CAT A specification with semi-exposed services.

## Accommodation

The accommodation comprises of the following

Name	sq ft	sq m	Tenure	Availability
4th	13,413	1,246.11	To let	Available
<b>Total</b>	<b>13,413</b>	<b>1,246.11</b>		

## Specification

- Newly refurbished manned reception
- Four pipe fan coil air-conditioning
- 24hr access
- Bike storage
- Shower Facilities
- Semi-exposed services
- Passenger and Goods lifts
- EPC B

## Terms

A new lease for a term by arrangement with the landlord.

Quoting Rent: £68.00 psf  
Service Charge c.£11.11 psf  
Rates c.£25.74 psf

## Viewings

Strictly by appointment.

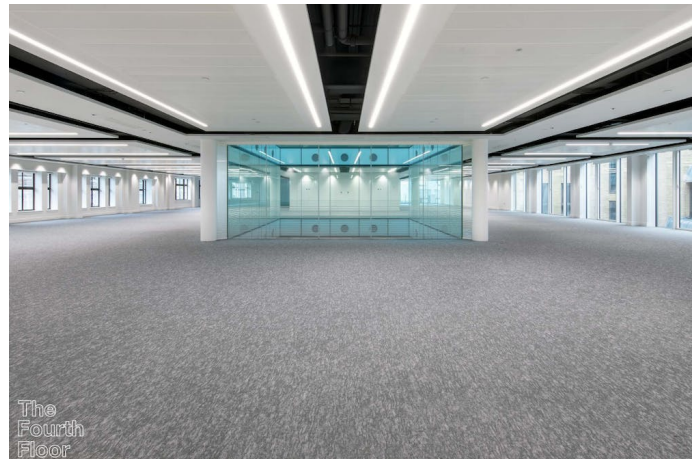

## Contact

### Artie Taylor

0207 758 3873

0786 620 3403

artie.taylor@savills.com

### Stuart Lawson

0207 499 8644

0787 055 5930

slawson@savills.com

### Josh Lamb

0207 409 8891

0797 698 8486

jlamb@savills.com

## IMPORTANT NOTICE

Savills, their clients and any joint agents give notice that: 1. They are not authorised to make or give any representations or warranties in relation to the property either here or elsewhere, either on their own behalf or on behalf of their client or otherwise. They assume no responsibility for any statement that may be made in these particulars. These particulars do not form part of any offer or contract and must not be relied upon as statements or representations of fact. 2. Any areas, measurements or distances are approximate. The text, photographs and plans are for guidance only and are not necessarily comprehensive. It should not be assumed that the property has all necessary planning, building regulation or other consents and Savills have not tested any services, equipment or facilities. Purchasers must satisfy themselves by inspection or otherwise. Generated by AgentsInsight / Generated on 21/09/2023

savills



The  
fourth

