

TO LET - OFFICE

THE ARC

225 City Road, EC1V 1JT



Key Highlights

- 11,474 to 130,723 sq ft
- CAT A Office Space
- Highly efficient radiant panel heating & cooling system
- WELL Gold
- Newly developed
- 100% Electric Power
- BREEAM 'Excellent'
- DGNB Certification

SAVILLS City
15 Finsbury Circus
London EC2M 7EB
020 7499 8644
[savills.co.uk](https://www.savills.co.uk)



Description

The Arc has been thoughtfully designed by AHMM and will provide 150,000 sq ft of top specification offices, together with retail and residential. The offices will be accessible via two prominent dedicated office entrances on City Road and Shepherdess Walk. The office accommodation occupies Levels 1 to 6 with typical floorplates of 20,000 – 26,000 sq ft and private terraces on Level 5 and a communal terrace on Level 7. Scheduled to complete in Q4 2023.

Location

The Arc occupies a prominent location at the intersection of City Road and Shepherdess Walk, the building is within 500m of Old Street station which is located to south east of the Site. The Bower, The Atlas Building, M by Motcalm Hotel, Eagle House, 250 City Road, Lexicon and Canaletto buildings have all recently completed to introduce new residential and commercial space on City Road. The world renowned Moorfields Eye Hospital is located directly opposite. The area around Old Street Roundabout is known as 'Silicon Roundabout' due to the abundance of technology companies who lead the UK technology industry.

Accommodation

The accommodation comprises of the following:

Name	sq ft	sq m	Availability
6th	20,464	1,901.17	Available
5th	20,461	1,900.89	Available
4th	26,108	2,425.51	Available
3rd	26,108	2,425.51	Available
2nd	26,108	2,425.51	Available
1st - part east	11,474	1,065.97	Available
1st - part west	11,805	1,096.72	Let
Ground	5,520	512.82	Let
Total	148,048	13,754.10	

Specification

- 100% electric power
- Highly efficient radiant panel heating and cooling system
- 237 bicycle spaces
- Locker and shower facilities
- BREEAM Excellent
- WELL Gold
- DGNB Certification

Contact

James Gillett

0207 409 8961

0797 200 0250

jjillett@savills.com

Artie Taylor

0207 758 3873

0786 620 3403

artie.taylor@savills.com

Jade Verona

0207 330 8617

0780 799 9783

jade.verona@savills.com

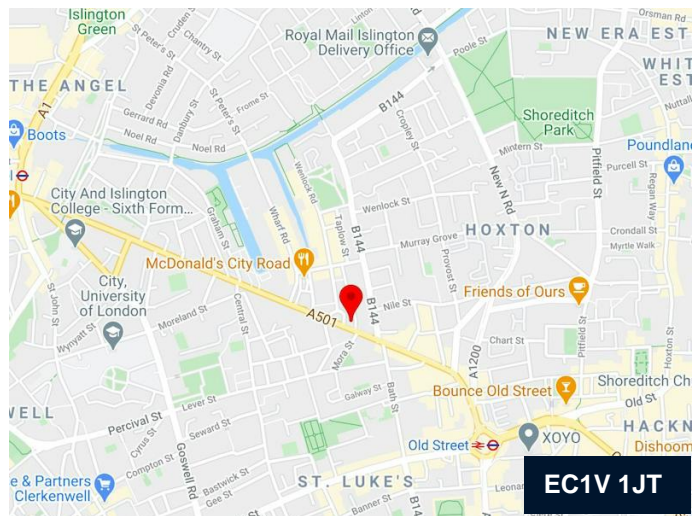
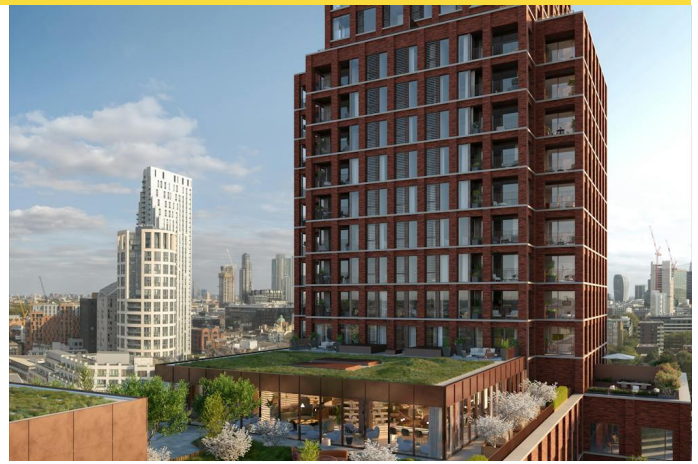

IMPORTANT NOTICE

Savills, their clients and any joint agents give notice that: 1. They are not authorised to make or give any representations or warranties in relation to the property either here or elsewhere, either on their own behalf or on behalf of their client or otherwise. They assume no responsibility for any statement that may be made in these particulars. These particulars do not form part of any offer or contract and must not be relied upon as statements or representations of fact. 2. Any areas, measurements or distances are approximate. The text, photographs and plans are for guidance only and are not necessarily comprehensive. It should not be assumed that the property has all necessary planning, building regulation or other consents and Savills have not tested any services, equipment or facilities. Purchasers must satisfy themselves by inspection or otherwise. Generated by AgentsInsight / Generated on 18/01/2024





