





- Popular Location
- Mid Terrace
- Allocated Parking
- Council Tax Band \*A\*
- Viewing Recommended
- Well Presented
- Two Bedrooms
- Freehold
- Great Views
- Call For More Information





\*\* Video Tour on our YouTube Channel |  
<https://youtu.be/NKHWjWlylbY> \*\*

Jan Forster Estates welcome to the market this well-presented two-bedroom mid terrace house. Located within a popular development, the property is close to many local amenities and excellent transport links, and will appeal to a variety of buyers, including first time buyers, downsizers, and investors alike.

Internally the house briefly comprises to the ground floor: - entrance hallway, handy downstairs WC, modern kitchen with floor and wall units, and a bright and airy lounge with French doors opening to the rear garden. To the first floor, there are two bedrooms, both with fitted wardrobes and a there is a modern family bathroom WC with shower over the bath. The property further benefits from gas central heating and double glazing.

Externally, there is a garden to the rear with a patio area and lawn. There is also an additional parking space to the rear of the property.

Early viewings come highly recommended. To book yours or for more information, please, call our Gateshead office on 0191 487 0800.

#### Tenure

The agent understands the property to be freehold. However, this should be confirmed with a licenced legal representative.

Council Tax band \*A\*.



## Ground Floor

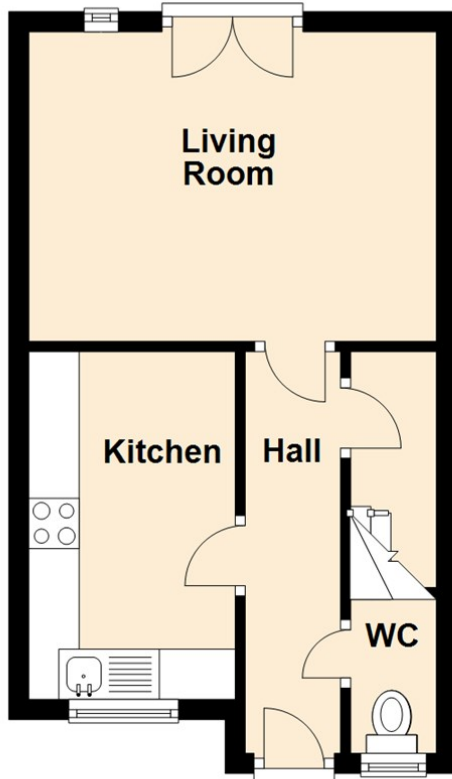

## First Floor

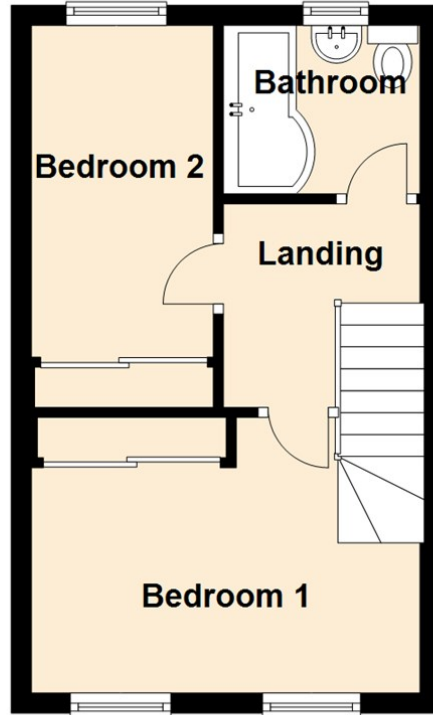

Living Room 10'1" x 13'3" (3.08 x 4.05)

Kitchen 11'4" x 6'8" (3.46 x 2.05)

Bedroom One 8'11" x 12'8" (2.74 x 3.87)

Bedroom Two 12'5" x 5'11" (3.80 x 1.81)

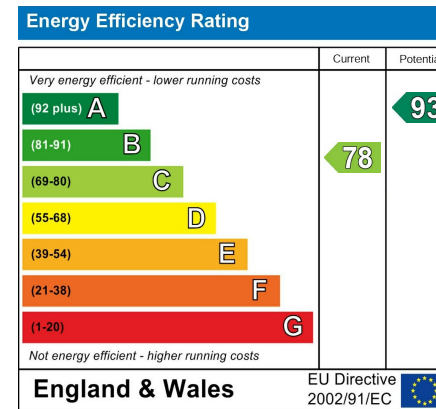

## The difference between house and home

You may download, store and use the material for your own personal use and research. You may not republish, retransmit, redistribute or otherwise make the material available to any party or make the same available on any website, online service or bulletin board of your own or of any other party or make the same available in hard copy or in any other media without the website owner's express prior written consent. The website owner's copyright must remain on all reproductions of material taken from this website.



[www.janforsterestates.com](http://www.janforsterestates.com)

Gosforth

0191 236 2070

Newcastle

0191 284 4050

High Heaton

0191 270 1122

Tynemouth

0191 257 2000

Low Fell

0191 487 0800

Property Management Centre

0191 236 2680

