



# Greenfields



## Whitethorn Avenue, Yiewsley UB7

Asking Price £459,950

Situated on a popular residential road is this beautifully presented two bedroom semi-detached house with garage & shared drive. The property has been carefully looked after by the owners and offers a generous floor plan.

Accommodation is arranged over two floors, on the ground floor there is an entrance porch opening into a bright reception room with a large window to the front aspect. To the rear is a modern kitchen with ample storage units as well as a breakfast bar. There is access to the rear garden from the kitchen. There is the added benefit of a downstairs cloak room.

On the first floor there are two double bedrooms with built in wardrobes providing plenty of storage space. There is a modern bathroom suite comprised of a corner panel enclosed bath tub, a corner shower cubicle, a low level wc and a wash hand basin.

There is a paved garden to the front while to the rear is a beautiful garden with mature shrubs and borders with artificial grass. There is a paved section to the front while to the rear is a large raised wooded decked area. There is the benefit of a garage to the rear.

- Two Bedrooms
- Semi-detached
- Excellent Condition
- Modern Kitchen
- Modern Bathroom
- Built-in Wardrobes
- Beautiful Rear Garden
- Garage

### Viewing

Please contact our Greenfields Office on 01895 628 560 if you wish to arrange a viewing appointment for this property or require further information.





## Floor Plan

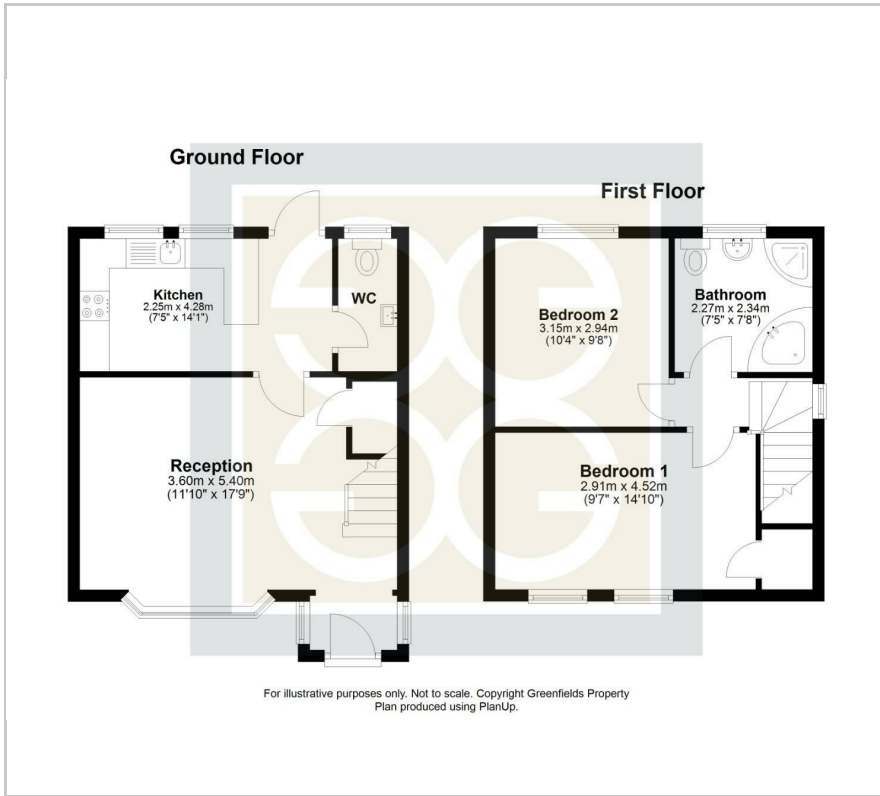

## Area Map



## Energy Efficiency Graph

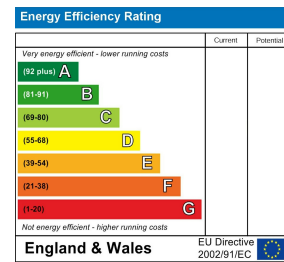

These particulars, whilst believed to be accurate are set out as a general outline only for guidance and do not constitute any part of an offer or contract. Intending purchasers should not rely on them as statements of representation of fact, but must satisfy themselves by inspection or otherwise as to their accuracy. No person in this firm's employment has the authority to make or give any representation or warranty in respect of the property.

115 Victoria Road, Ruislip, Middlesex, HA4 9BN

Tel: 01895 628 560 Email: [info@greenfieldsproperty.co.uk](mailto:info@greenfieldsproperty.co.uk) [www.greenfieldsproperty.co.uk](http://www.greenfieldsproperty.co.uk)