



MEDDINS LANE, Kinver, DY7 6DD

Offers In Region Of £400,000

3 1 2

- A beautiful THREE BEDROOM link-detached Bungalow.
- Thoughtfully extended over the years.
- Plenty of off road parking to the Front.
- An early and internal viewing is essential to appreciate the living accommodation on offer.
- Occupying this prime Kinver Address, within close proximity of countryside walks and Kinver Edge.
- Includes a good sized Kitchen, Modern Bathroom, Three well presented Bedrooms and a good sized Rear Garden.
- EPC Rating TBC.



Occupying this SOUGHT AFTER KINVER ADDRESS, this beautifully presented TRADITIONAL THREE BEDROOM LINK-DETACHED BUNGALOW has been thoughtfully extended over the years, benefiting from ready to move in living accommodation to include a spacious Living Room, Dining Room, good sized Kitchen, Three spacious Bedrooms, a modern Bathroom and a beautiful well cared for and long Rear Garden. Having Kinver Edge and Countryside walks just a few minutes away, this is a Bungalow that has to be viewed.



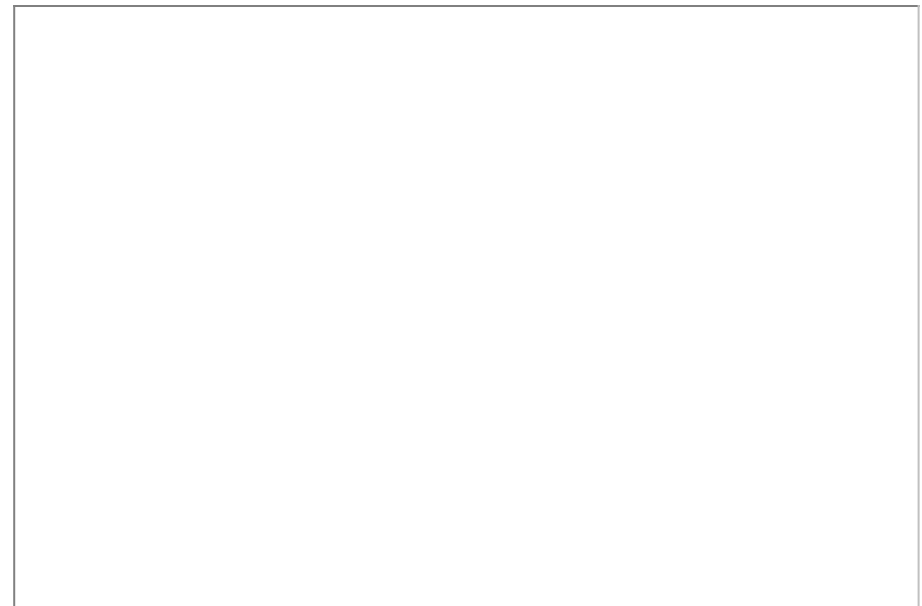
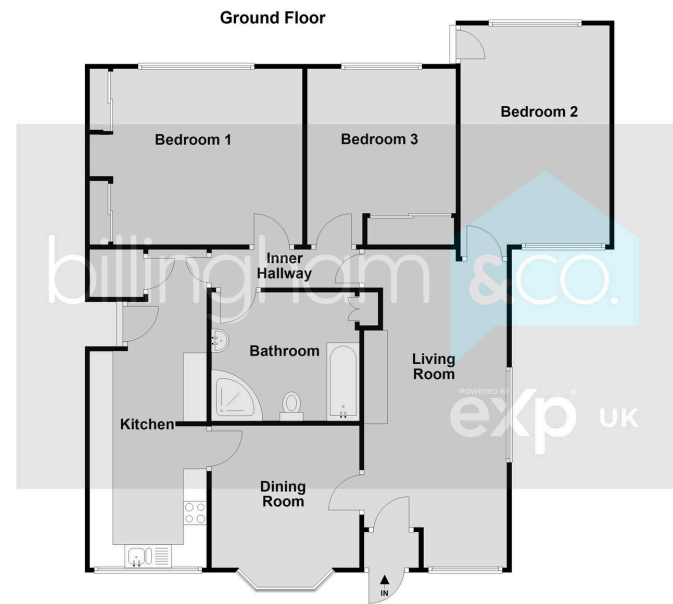

Sales 01384 444 004 / Lettings 01384 445 075
 hello@bilingham.properties
 www.bilingham.properties



Agents Note: Whilst every care has been taken to prepare these particulars, they are for guidance purposes only. All measurements are approximate and are for general guidance purposes only and whilst every care has been taken to ensure their accuracy, they should not be relied upon and potential buyers are advised to recheck the measurements.