



# HEATH LANE, Oldswinford, Stourbridge, DY8 1RQ

Offers In Region Of £225,000

🛏️ 2 🚿 1 🚗 2

- A WELL PRESENTED TWO BEDROOM MID TERRACED period home.
- Situated within the heart of Oldswinford.
- Having a Living Room, Dining Room, Cellar, Kitchen.
- Benefiting from a long Rear Garden.
- EPC Rating TBC.
- Offering plenty of character and charm.
- Within woking distance of Mary Stevens Park and Old Swinford Hospital School.
- With good sized Bedrooms, Refitted Shower Room
- Having NO UPWARD CHAIN, an early viewing is advised.



A WELL PRESENTED TWO BEDROOM MID TERRACED period home, offering plenty of character and charm and pleasantly situated within the heart of OLDSWINFORD, having Mary Stevens Park and Old Swinford Hospital School within walking distance and within close proximity of great transport links to include Stourbridge Junction. Comprising of a Living Room, Dining Room, Cellar, Kitchen, Two good sized Bedrooms, a Refitted Shower Room and a good sized Rear Garden. **HAVING NO UPWARD CHAIN**, an early viewing is advised.



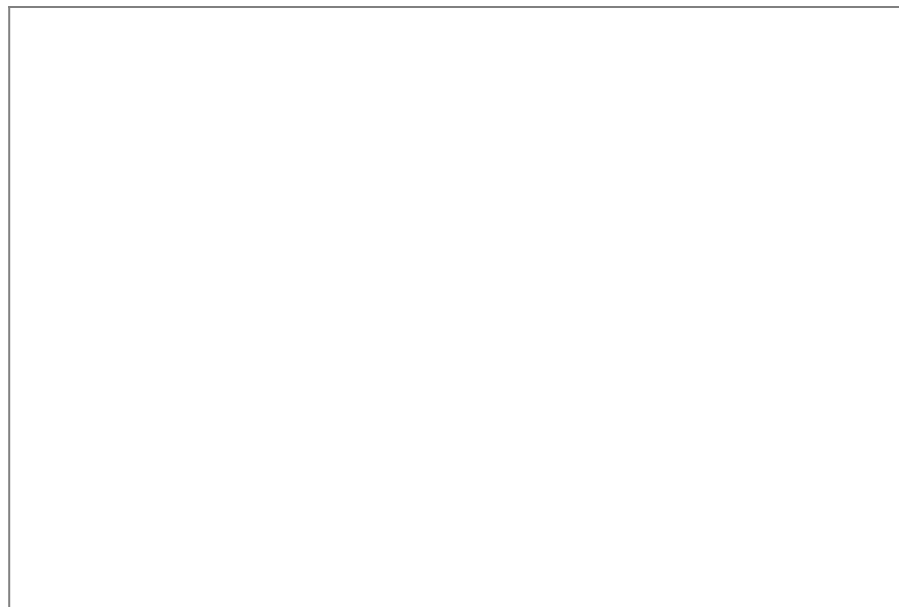
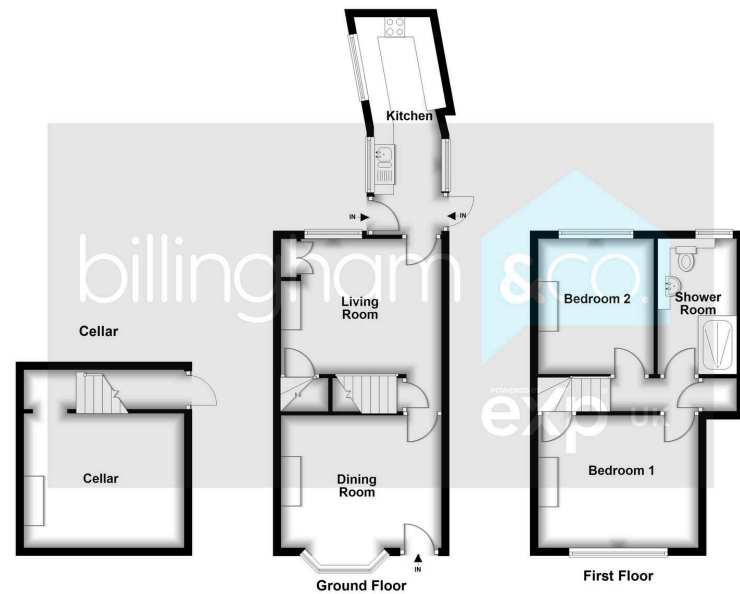

Sales 01384 444 004 / Lettings 01384 445 075  
 hello@bilingham.properties  
 www.bilingham.properties



Agents Note: Whilst every care has been taken to prepare these particulars, they are for guidance purposes only. All measurements are approximate and are for general guidance purposes only and whilst every care has been taken to ensure their accuracy, they should not be relied upon and potential buyers are advised to recheck the measurements.