



Lavender Lane, NORTON, Stourbridge, DY8 3EL

Offers In Region Of £290,000

3 1 2



- Beautifully presented
- Spacious and extended
- Three-bedroomed semi-detached home
- Sought after Norton location
- Three good-sized bedrooms
- Recently replaced central heating boiler
- Driveway parking for several vehicles
- Book your viewing today!



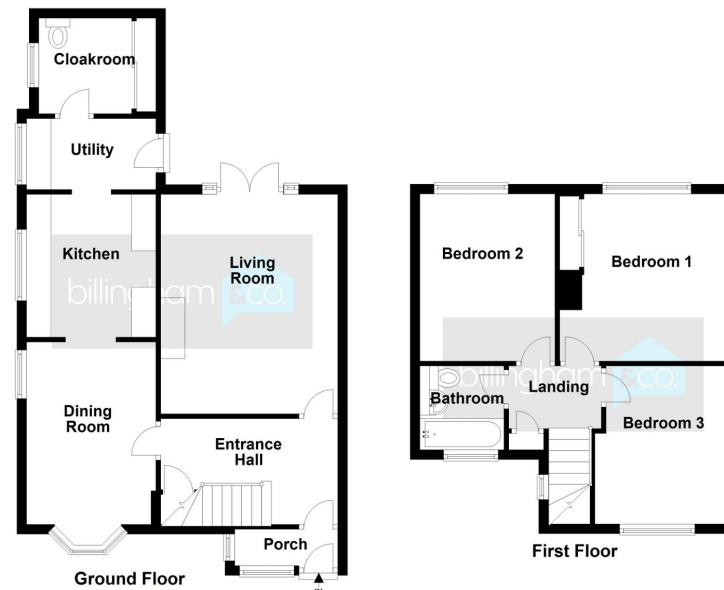

A beautifully presented, spacious and extended three-bedroomed semi-detached home situated in a sought after Norton location. The accommodation comprises: welcoming entrance hall, spacious lounge with patio doors overlooking the garden, separate dining room leading onto a modern fitted kitchen, utility area and large ground floor WC with storage. On the first floor the landing provides access to three good-sized bedrooms and the family bathroom. There is also an airing cupboard with a recently replaced central heating boiler. At the front of the property is driveway parking for several vehicles. Behind the property is a paved patio and garden laid to lawn. This property want be on the market for long - Book your viewing today!

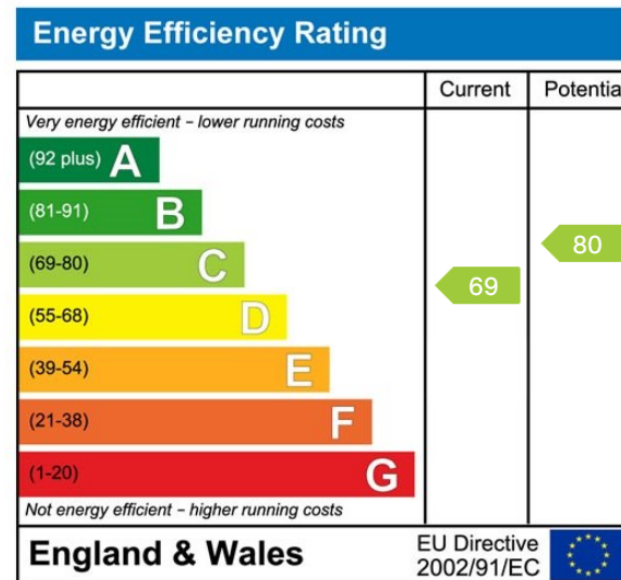

Sales 01384 444 004 / Lettings 01384 445 075
 hello@billingham.properties
 www.billingham.properties



Agents Note: Whilst every care has been taken to prepare these particulars, they are for guidance purposes only. All measurements are approximate and are for general guidance purposes only and whilst every care has been taken to ensure their accuracy, they should not be relied upon and potential buyers are advised to recheck the measurements.