

FREEHOLD



House - Mid Terrace

9 JEPHTHA ROAD,
LONDON, LONDON,
SW18 1QH

Offers in excess of

£900,000

FEATURES

- CHAIN FREE
- FREEHOLD
- RENOVATION
- PROBATE GRANTED
- GARDEN
- GREAT LOCATION



THE
**ESTATES
AGENT**
PROPERTY SALES & MANAGEMENT

3 Bedroom House - Mid Terrace located in London

Call us on

020 3859 5311

info@theestatesagent.co.uk

Renovation Project: 3-Bedroom Victorian Terraced House in SW18

Seize a fantastic opportunity with this 3-bedroom Victorian terraced house located conveniently near East Putney Station. This property, in need of modernisation, offers a blank canvas for your creative vision in a prime and sought-after location.

Key Features:

Three Bedrooms: Customise three bedrooms to suit your family's needs or create additional spaces like a home office.

Victorian Charm: Embrace the unique features and character of a Victorian terraced house, offering a glimpse into the rich architectural history.

In Need of Modernisation: This property presents an excellent opportunity for renovation, allowing you to add significant value and create a modern and stylish living space.

Location: Enjoy the convenience of being local to East Putney Station, providing easy access to transport links and amenities.

Council Tax Band

F

Jephtha Road, London, SW18

Approximate Area = 1243 sq ft / 115.4 sq m (excludes wc)

For identification only - Not to scale

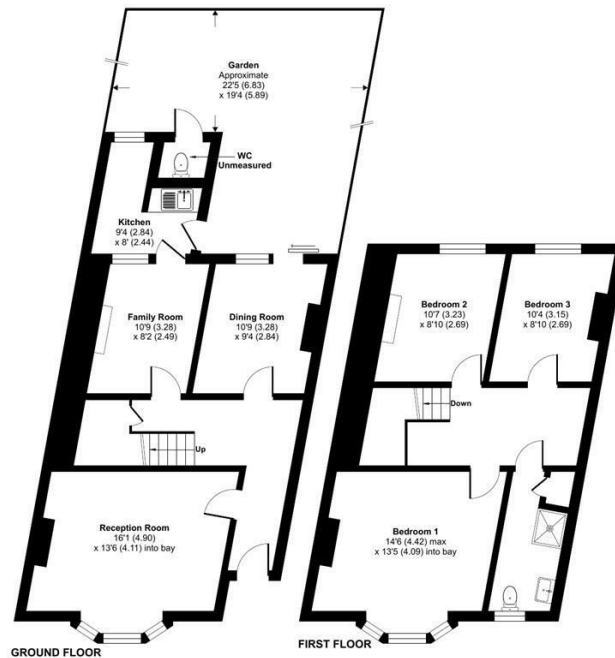

Floor plan produced in accordance with RICS Property Measurement Standards incorporating International Property Measurement Standards (IPMS2 Residential). © richrecom 2023. Produced for: Flanders International Estate Agents, REF: 1002001

Energy Efficiency Rating		Current	Potential
<i>Very energy efficient - lower running costs</i>			
(92 plus)	A		89
(81-91)	B		
(69-80)	C	69	
(55-68)	D		
(39-54)	E		
(21-38)	F		
(1-20)	G		
<i>Not energy efficient - higher running costs</i>			
England & Wales		EU Directive 2002/91/EC	

Agents Note: Whilst every care has been taken to prepare these particulars, they are for guidance purposes only. All measurements are approximate and are for general guidance purposes only and whilst every care has been taken to ensure their accuracy, they should not be relied upon and potential buyers are advised to recheck the measurements.