



Harvester Way
Buckingham Fields, Northampton

oriordanbond
SALES & LETTINGS



Harvester Way

Buckingham Fields

NN4 8JZ

PRICE £269,995

A three bedroom semi-detached property, located within the heart of Buckingham Fields estate, close to Hunsbury Shopping Centre and the highly regarded Wootton Park School.

The accommodation comprises entrance hall, cloakroom/WC, open plan sitting/dining room with French doors opening onto the garden and kitchen with oven, hob and extractor fan. The first floor offers a master bedroom with en-suite, two further bedrooms and a family bathroom. Outside is a small front garden and driveway to the side providing off road parking. To the rear is a private enclosed garden. Further benefits include uPVC double glazing and gas radiator heating. (B/850/M)

Additional information

- Council Tax Band: B
- Energy Efficiency Rating: B

Viewing

Viewing strictly by appointment – details below

Disclaimer

O’Riordan Bond Estate Agents Limited has not tested apparatus, equipment, fittings or services and so cannot verify they are in working order. The buyer is advised to obtain verification from their solicitor or surveyor.

O’Riordan Bond Far Cotton Sales

01604 706007

farcofotton@oriordanbond.co.uk



GROUND FLOOR

1ST FLOOR

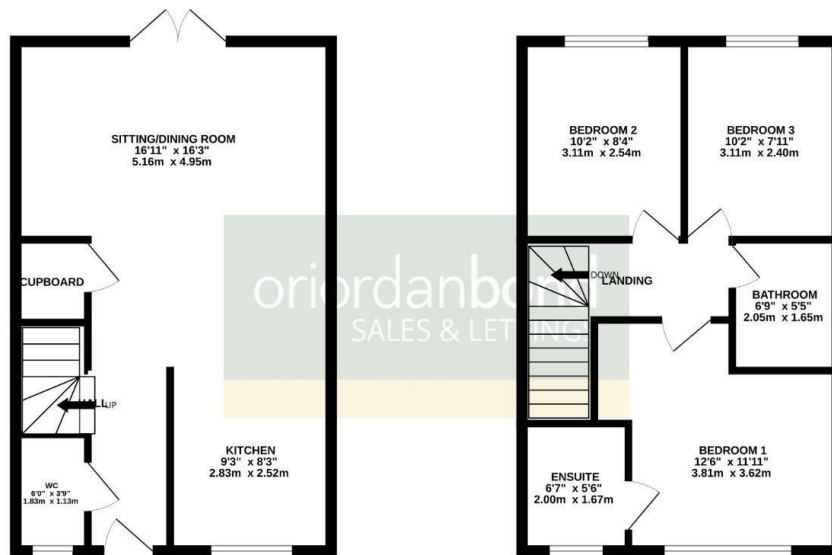

TOTAL FLOOR AREA : 850 sq.ft. (79.0 sq.m.) approx.

Whilst every attempt has been made to ensure the accuracy of the floorplan contained herein, measurements of doors, windows, rooms and any other items are approximate and no responsibility is taken for any error, omission or mis-statement. This plan is for illustrative purposes only and should be used as such by any prospective purchaser. The services, systems and appliances shown have not been tested and no guarantee as to their operability or efficiency can be given.

Made with Metropac (02024)