



Parkfield Avenue

Delapre, Northampton

oriordanbond
SALES & LETTINGS



Parkfield Avenue

Delapre

NN4 8QD

OFFERS OVER £260,000

A mature three bedroom double bay fronted semi-detached home with off road parking and garage is offered for sale in the very popular Delapre, part of NN4.

Accommodation comprises entrance hall with stairs to first floor, sitting room with bay window to front elevation, dining room with feature fireplace and door to garden and a fitted kitchen with door to lean-to with access to the front and rear garden. To the first floor are three bedrooms and a family bathroom. The property offers off road parking to the front for two vehicles and there is a private enclosed rear garden with patio to the immediate rear and the remainder laid to lawn leading to a single brick-built garage accessed via a rear service road. Further benefits include uPVC double glazing and gas radiator heating. (C/820/M)

Additional information

- Council Tax Band: C
- Energy Efficiency Rating: E

Viewing

Viewing strictly by appointment – details below

Disclaimer

O'Riordan Bond Estate Agents Limited has not tested apparatus, equipment, fittings or services and so cannot verify they are in working order. The buyer is advised to obtain verification from their solicitor or surveyor.

O'Riordan Bond Far Cotton Sales

01604 706007

farcotton@oriordanbond.co.uk

FIRST FLOOR
388 sq.ft. (36.0 sq.m.) approx.

GROUND FLOOR
432 sq.ft. (40.1 sq.m.) approx.

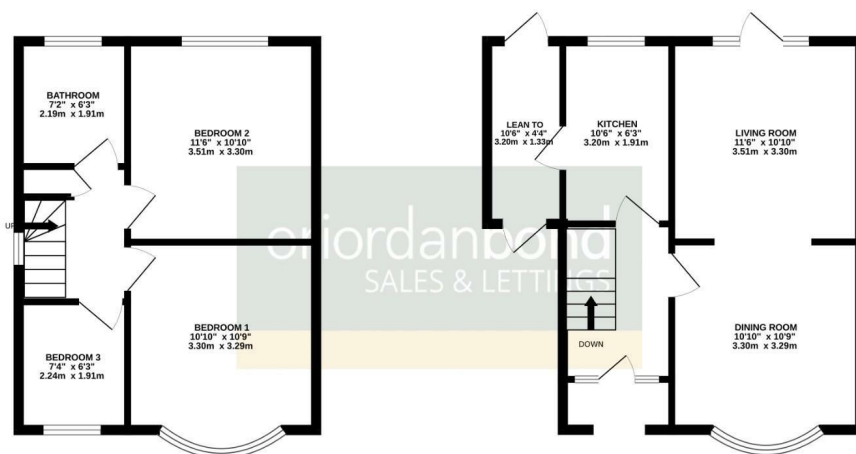

Whilst every attempt has been made to ensure the accuracy of the floorplan contained here, measurements of doors, windows, rooms and any other items are approximate and no responsibility is taken for any error, omission or mis-statement. This plan is for illustrative purposes only and should be used as such by any prospective purchaser. The services, systems and appliances shown have not been tested and no guarantee as to their operability or efficiency can be given.
Made with Metropix 02024

