

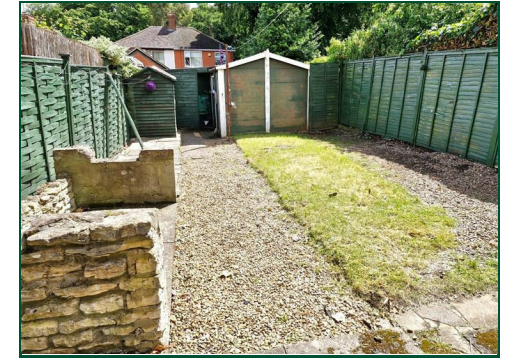

**Parkfield Avenue**  
Delapre, Northampton

**oriordanbond**  
SALES & LETTINGS





## Parkfield Avenue

Delapre

NN4 8QD

PRICE £249,995

Offered to the market with no onward chain is this mature, three bedroom double bay fronted semi-detached home situated in the popular area of Delapre. This property is in need of some cosmetic updating throughout and offers accommodation over two floors.

Accommodation comprises entrance hall with stairs to first floor, sitting room with bay window to the front, dining room with French doors to rear garden, kitchen with door to lean-to which runs from front to rear of the property providing access to the rear garden, three first floor bedrooms and a family shower room. Outside, to the front is a driveway providing off road parking for two cars. To the rear is a private enclosed garden and single garage accessed via a rear service road. Further benefits include gas radiator heating and uPVC double glazing. (C/992/M)

### Additional information

- Council Tax Band: C
- Energy Efficiency Rating: D

### Viewing

Viewing strictly by appointment – details below

### Disclaimer

O'Riordan Bond Estate Agents Limited has not tested apparatus, equipment, fittings or services and so cannot verify they are in working order. The buyer is advised to obtain verification from their solicitor or surveyor.

O'Riordan Bond Far Cotton Sales

01604 706007

farcotton@oriordanbond.co.uk

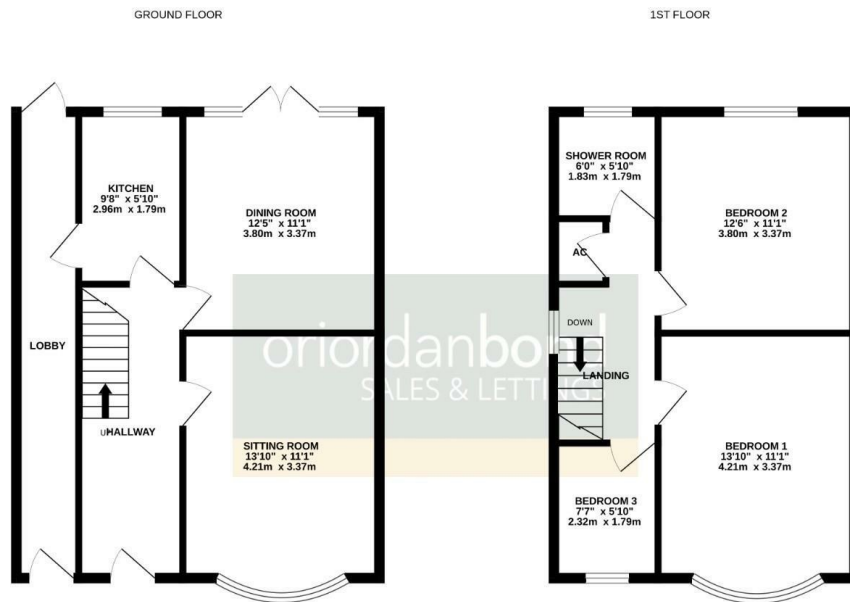

TOTAL FLOOR AREA : 992 sq. ft. (92.2 sq. m.) approx.

Whilst every attempt has been made to ensure the accuracy of the floorplan contained here, measurements of doors, windows, rooms and any other items are approximate and no responsibility is taken for any error, omission or mis-statement. This plan is for illustrative purposes only and should be used as such by any prospective purchaser. The services, systems and appliances shown have not been tested and no guarantee as to their operability or efficiency can be given.

Made with Metropix 62024