

Rolfe East



MCDOWELL STREET, HERTFORDSHIRE, CM23 2AT

£87,500

- White bathroom suite with thermostatic shower
- Gas central heating
- SHARED OWNERSHIP - PRICE REFLECTS 25% OF THE FULL MARKET VALUE
- Completion Summer 2025
- Carpet throughout living areas
- Allocated parking
- Rent and service charge payable per month
- Vinyl flooring in kitchen & bathroom
- Fitted kitchen with integrated oven and hob, washer dryer & fridge freezer
- Eligibility and affordability criteria apply



FIRST FLOOR

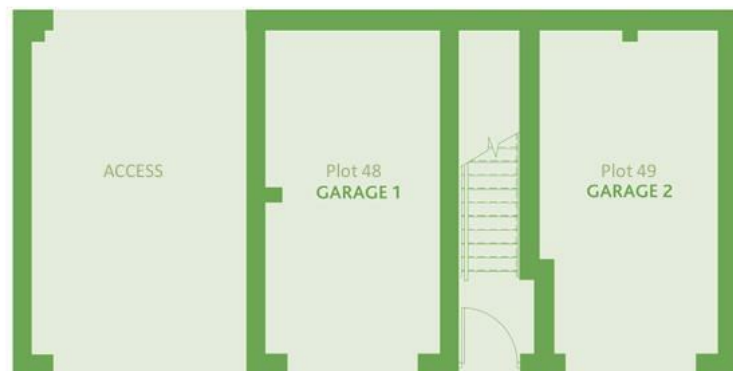

GROUND FLOOR

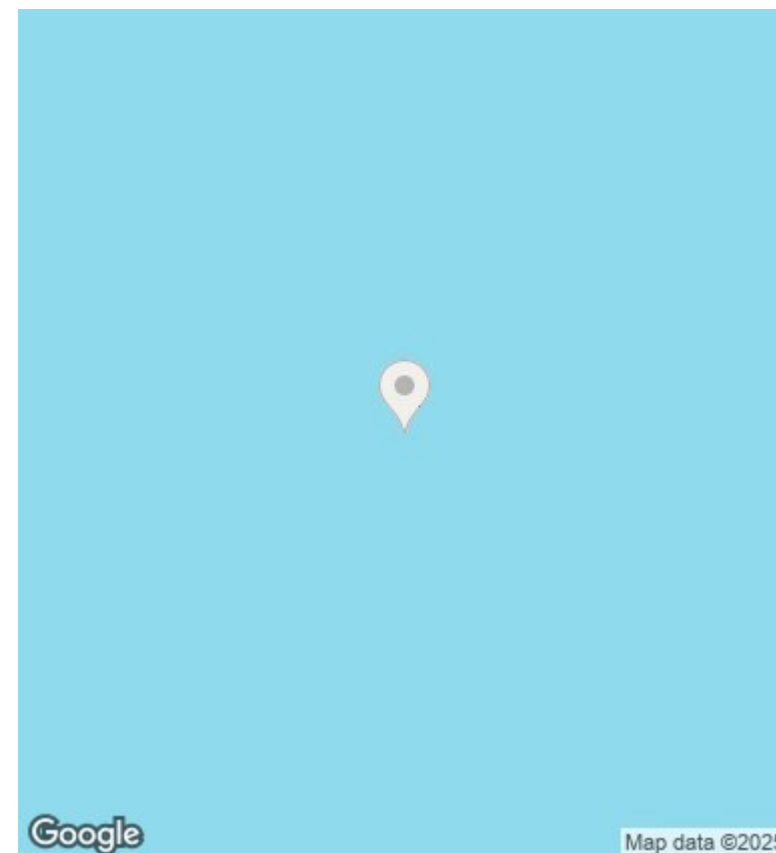

Directions

Viewings

Viewings by arrangement only. Call 020 8579 4080 to make an appointment.

Council Tax Band

New Build

EPC Rating:

Energy Efficiency Rating		
	Current	Potential
Very energy efficient - lower running costs		
(92 plus) A		
(81-91) B		
(69-80) C		
(55-68) D		
(39-54) E		
(21-38) F		
(1-20) G		
Not energy efficient - higher running costs		
England & Wales	EU Directive 2002/91/EC	