

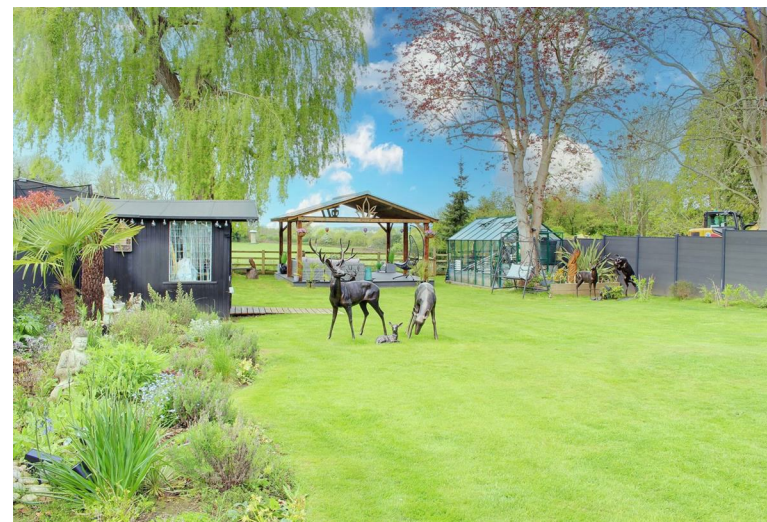

MEADOW END, 18 BELL LANE, BROOKMANS PARK AL9 7AY

Guide Price £1,395,000 | Freehold

ANDREW WARD^{EST 1988}
ESTATE AGENTS



Property Overview

A beautifully presented detached family house situated in this idyllic semi rural position with stunning West facing landscaped garden backing directly onto open countryside. The property offers spacious living space comprising entrance hall with cloakroom, fabulous split level dining room to living room with sliding doors to garden, spacious sitting room, study/snug, contemporary newly fitted kitchen with integrated appliances and utility room. To the first floor there are three double bedrooms (two with en suites) and modern family bathroom. The property is approached by an independent driveway with garage storage with stunning West facing garden to rear with raised patio (ideal for entertaining) with extensive lawn with fantastic Pergola enjoying far countryside views.





Property Features

- Living Room: 20'11 x 15'1
- Sitting Room: 25'7 x 18'8
- Dining Room: 20'11 x 10'4
- Snug: 14'1 x 10'3
- Family Bathroom
- Master Bedroom with Dressing Area & En Suite: 20'9 x 13'1
- Bedroom Two with En Suite: 14'9 x 8'10
- Bedroom Three: 11'5 x 9'6
- Kitchen: 12'9 x 10'7 & Utility:
- Landscaped 105ft West Facing Garden

Agents Notes

The property sits on a beautiful plot of just over 0.2 of an acre backing directly onto open countryside. The property also offers massive scope to extend further (subject to planning) and has been modernised to provide flexible accommodation.

GROUND FLOOR
1663 sq.ft. (154.5 sq.m.) approx.



1ST FLOOR
697 sq.ft. (64.8 sq.m.) approx.

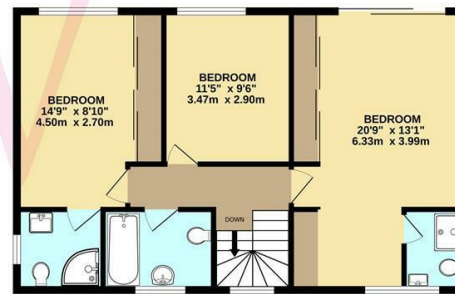

TOTAL FLOOR AREA: 2360 sq.ft. (219.2 sq.m.) approx.

Whilst every attempt has been made to ensure the accuracy of the floorplan contained here, measurements of doors, windows, rooms and any other items are approximate and no responsibility is taken for any error, omission or mis-statement. This plan is for illustrative purposes only and should be used as such by any prospective purchaser. The services, systems and appliances shown have not been tested and no guarantee as to their operability or efficiency can be given.
Made with Metropix ©2025



Contact us

35 Bradmore Green, Brookmans Park, Herts, AL9 7QR
01707 649779 | brookmanspark@andrewward.co.uk

www.andrewward.co.uk

Our Offices

BARNET
175 High Street, Barnet EN5 5SU
Tel: 020 8441 6000
Email: barnet@andrewward.co.uk

BROOKMANS PARK
35 Bradmore Green, Brookmans Park AL9 7QR
Tel: 01707 649779
Email: brookmanspark@andrewward.co.uk

POTTERS BAR
149 High Street, Potters Bar EN6 5BB
Tel: 01707 657181
Email: pottersbar@andrewward.co.uk

Disclaimer: "These property particulars, including floor plans, are set out as a general outline only for guidance and DO NOT constitute any part of an offer or contract. Any purchaser or other must satisfy themselves by inspection or otherwise as to their accuracy. All measurements are given as approximate, no survey or testing of appliances has been carried out. No employee of Andrew Ward Estate Agents has the authority to make or give any representation or warranty in respect of the property."

All enquiries and negotiations must be carried out through Andrew Ward Estate Agents.

ANDREW WARD EST. 1988
ESTATE AGENTS