



1 TOLMERS MEWS, NEWGATE STREET SG13 8RG

Guide Price £650,000 | Freehold

ANDREW WARD EST. 1988
ESTATE AGENTS



Property Overview

A stunning two double bedroom lodge forming part of a former Georgian coach house with beautiful gardens, stunning communal grounds and gated entrance. Situated in a pretty mews the property offers versatile living space comprising entrance hall, spacious living room with feature exposed brick work, fitted kitchen, two good size double bedrooms one with built in wardrobes and the other with French doors to garden and modern fully tiled bathroom. To the rear are beautiful cottage style gardens with an abundance of flowers and plants with rear gated pedestrian access. Approached by an electric gated entrance the property forms part of a glorious former Georgian estate with use of wonderful mature communal grounds.



Property Features

- Entrance Hall
- Living Room: 21'4 x 16'7
- Kitchen: 12'3 x 9'10
- Beautiful Garden
- Private Mews Setting
- Master Bedroom: 16'9 x 14'9
- Bedroom Two: 18'1 x 9'4
- Luxury Bathroom
- Gated Entrance
- Wonderful Mature Communal Grounds

Agents Notes

The property boasts a wealth of period charm and character throughout along with being set in an idyllic country house setting. All mains utilities apply with parking areas and pretty courtyard gardens approach. Situated within a short drive of Cuffley, Brookmans Park & Potters bar with there main line train services into London.

GROUND FLOOR
843 sq.ft. (78.3 sq.m.) approx.

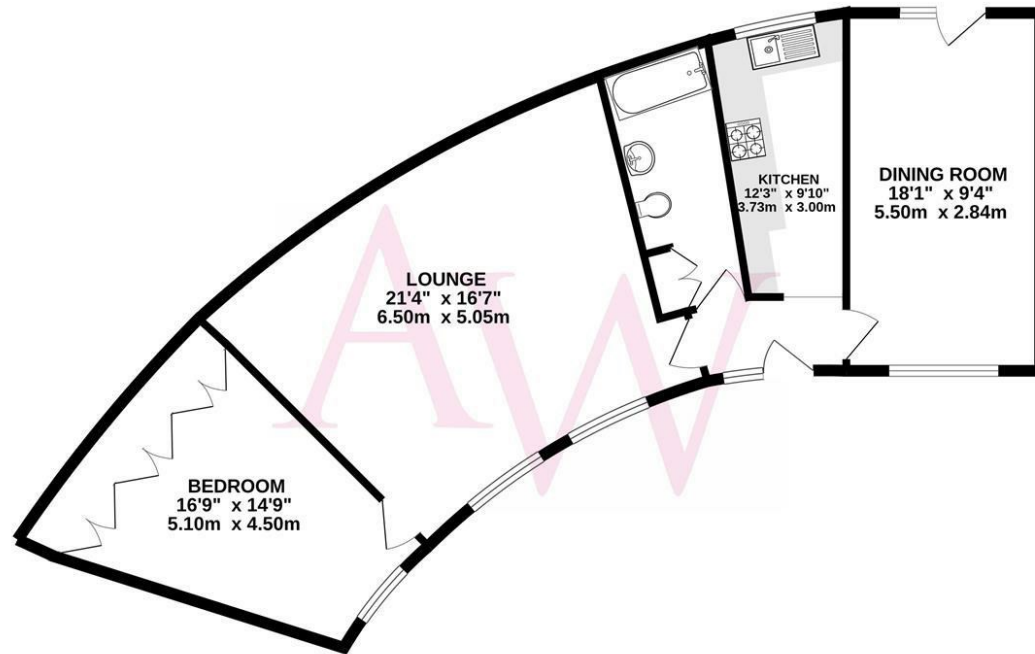

TOTAL FLOOR AREA: 843 sq.ft. (78.3 sq.m.) approx.

Whilst every attempt has been made to ensure the accuracy of the floorplan contained here, measurements of doors, windows, rooms and any other items are approximate and no responsibility is taken for any error, omission or mis-statement. This plan is for illustrative purposes only and should be used as such by any prospective purchaser. The services, systems and appliances shown have not been tested and no guarantee as to their operability or efficiency can be given.
Made with Metropix ©2024



Contact us

35 Bradmore Green, Brookmans Park, Herts, AL9 7QR
01707 649779 | brookmanspark@andrewward.co.uk

www.andrewward.co.uk

Our Offices

BARNET
175 High Street, Barnet EN5 5SU
Tel: 020 8441 6000
Email: barnet@andrewward.co.uk

BROOKMANS PARK
35 Bradmore Green, Brookmans Park AL9 7QR
Tel: 01707 649779
Email: brookmanspark@andrewward.co.uk

POTTERS BAR
149 High Street, Potters Bar EN6 5BB
Tel: 01707 657181
Email: pottersbar@andrewward.co.uk

Disclaimer: "These property particulars, including floor plans, are set out as a general outline only for guidance and DO NOT constitute any part of an offer or contract. Any purchaser or other must satisfy themselves by inspection or otherwise as to their accuracy. All measurements are given as approximate, no survey or testing of appliances has been carried out. No employee of Andrew Ward Estate Agents has the authority to make or give any representation or warranty in respect of the property."

All enquiries and negotiations must be carried out through Andrew Ward Estate Agents.

ANDREW WARD EST. 1988
ESTATE AGENTS