

POTTERS BAR
149 High Street, Potters Bar EN6 5BB
Tel: 01707 657181
Email: pottersbar@andrewward.co.uk

BROOKMANS PARK
35 Bradmore Green, Brookmans Park AL9 7QR
Tel: 01707 649779
Email: brookmanspark@andrewward.co.uk

Disclaimer: "These property particulars, including floor plans, are set out as a general outline only for guidance and DO NOT constitute any part of an offer or contract. Any purchaser or other must satisfy themselves by inspection or otherwise as to their accuracy. All measurements are given as approximate, no survey or testing of appliances has been carried out. No employee of Andrew Ward Estate Agents has the authority to make or give any representation or warranty in respect of the property."

All enquiries and negotiations must be carried out through Andrew Ward Estate Agents.

BARNET
175 High Street, Barnet EN5 5SU
Tel: 020 8441 6000
Email: barnet@andrewward.co.uk

175 High Street, Barnet, Herts, EN5 5SU
barnet@andrewward.co.uk | 020 8441 6000
www.andrewward.co.uk

Our Offices

Contact us

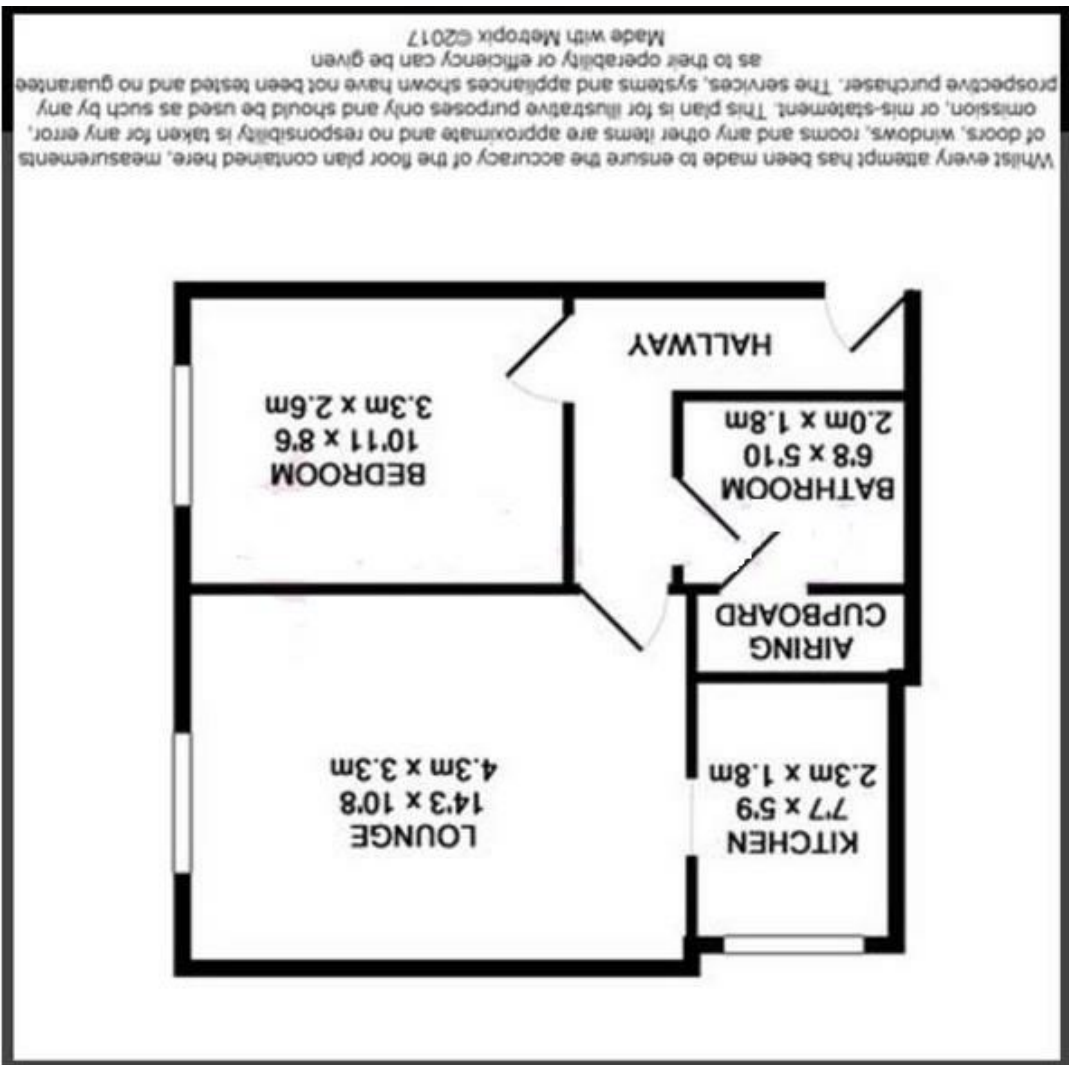

FLAT 17 GILLINGS COURT, WOOD STREET, BARNET EN5 4BU

Asking Price £260,000 | Share of Freehold



Property Overview

FIRST TIME BUYER OR BUY TO LET INVESTOR

Ideally positioned at the back of Gillings Court and close to High Barnet High Street and High Barnet Underground Station (Northern Line) is this well presented and recently decorated one bedroom first floor apartment which includes an allocated parking space. The property comprises of a bright and spacious living room featuring oak flooring, a stylish kitchen with handleless cupboards and splash back tiles, a good sized master bedroom and a fully tiled separate bathroom to finish.



Property Features

- LIVING ROOM - 14'3 X 10'11
- BEDROOM - 11'0 X 8'7
- BATHROOM - 6'8 X 5'10
- KITCHEN - 7'7 X 6'6
- ALLOCATED PARKING SPACE
- CLOSE TO HIGH BARNET UNDERGROUND STATION AND HIGH STREET

Agents Notes

Further benefits include extra storage cupboards, entrance hallway, audio entry.

Remaining underlying lease: Circa. 976 years
Service charges: Circa. £1,700 per annum

Gillings Court is situated on Wood Street which is in close proximity to High Barnet High Street with all of its shops, cafes, restaurants. Also within walking distance is High Barnet Underground Station (Northern Line)