



2 Kings Meadow, North Chailey BN8 4AA

£225,000



**MANSELL
McTAGGART**
— Trusted since 1947 —

2 Kings Meadow

A recently built (2019) ONE BEDROOM GROUND FLOOR FLAT with communal lawned garden & allocated parking space.

The main front door leads into an attractive communal entrance hall off which is your own front door into the flat. This leads into the hall which has a large walk in storage cupboard with automatic electric light.

Off the hall is the light OPEN PLAN LIVING/DINING/KITCHEN SPACE, the well equipped kitchen area includes an electric oven, a gas hob, fridge/freezer, washing machine & dishwasher.

The double bedroom has a mirror fronted wardrobe and there is a modern bathroom. Further benefits include gas fired central heating & double glazing.

Outside there is an allocated parking space (number 2) and lovely lawned COMMUNAL GARDENS.

- A RECENTLY BUILT (2019) ONE BEDROOM GROUND FLOOR FLAT WITH COMMUNAL GARDENS & ALLOCATED PARKING
- COMMUNAL ENTRANCE HALL & OWN HALL
- OPEN PLAN KITCHEN/DINING/LIVING AREA
- BEDROOM
- BATHROOM
- LAWNED COMMUNAL GARDENS & ALLOCATED PARKING SPACE
- LEASEHOLD EPC B COUNCIL TAX BAND C LEWES
- LEASE 117 YEARS REMAINING SERVICE CHARGE £138.71 per month





2 Kings Meadow

The popular village of North Chailey has a garage with shop. Nearby are the extensive open areas of Chailey Common Nature Reserve which is interspersed with bridleways and footpaths, being just a short walk from the property. The town centre of Haywards Heath (about 5 miles) provides a comprehensive shopping centre, excellent leisure facilities and a fast and frequent main line train service to both London (Victoria/London Bridge 45 minutes) and Brighton.

Newick village centre (about 2 miles) provides further local amenities including a selection of village shops, outstanding primary school, 3 pubs and a modern area health centre. A further primary school can also be found at Chailey Green and a secondary school at South Chailey.

DIRECTIONS

From our office on the green at Newick head west along the A272 in the direction of Haywards Heath until reaching the two mini-roundabouts at North Chailey. Turn left at the second mini roundabout and Kings Meadow will be on your left.



Ground Floor

Approx. 49.1 sq. metres (528.4 sq. feet)

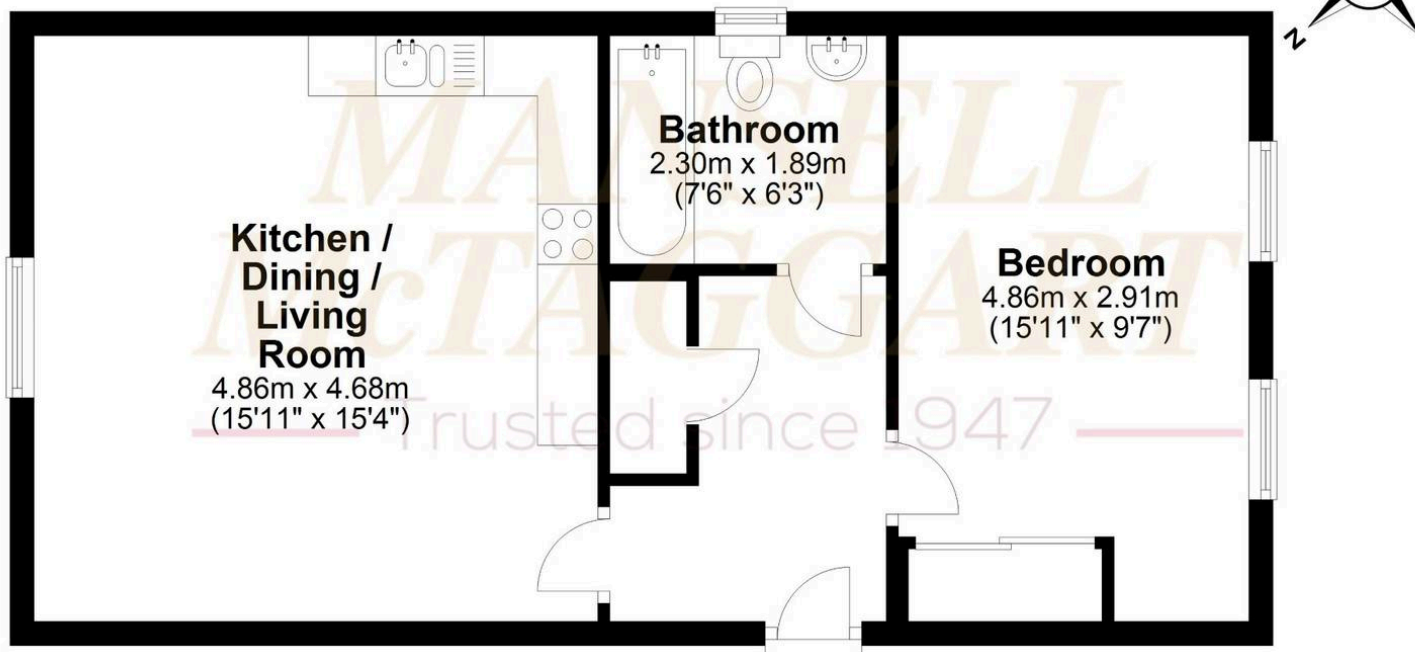

Total area: approx. 49.1 sq. metres (528.4 sq. feet)

Illustration for guidance purposes only and not to scale. Measurements are approximate.

Copyright Roots Property Marketing.

Plan produced using PlanUp.

Mansell McTaggart Newick

Mansell McTaggart, 3a The Green - BN8 4LA

01825 722288

new@mansellmctaggart.co.uk

www.mansellmctaggart.co.uk/branch/newick

Consumer Protection from Unfair Trading Regulations 2008 We have not tested any apparatus, equipment, fixtures, fittings or services and so cannot verify that they are in working order or fit for purpose. You are advised to obtain verification from your solicitor or surveyor. References to the tenure of a property are based on information supplied by the seller. We have not had sight of the title documents and a buyer is advised to obtain verification from their solicitor. Items shown in photographs are not included unless specifically mentioned within the sales particulars, but may be available by separate negotiation.