



## Quex Road, NW6

£403 Per week

A modern one bedroom apartment featuring wooden floors throughout and underfloor heating. The bathroom is stylish and includes a shower.

Located on Quex Road, the property is close to Kilburn Park Tube, the Overground, and West Hampstead Stations. There are many shops, pubs, and cafes nearby.

### Features

Modern  
One Bedroom  
Open Plan Living  
Wooden Floors  
Second Floor Flat  
Excellent Storage

# Quex Road, London, NW6

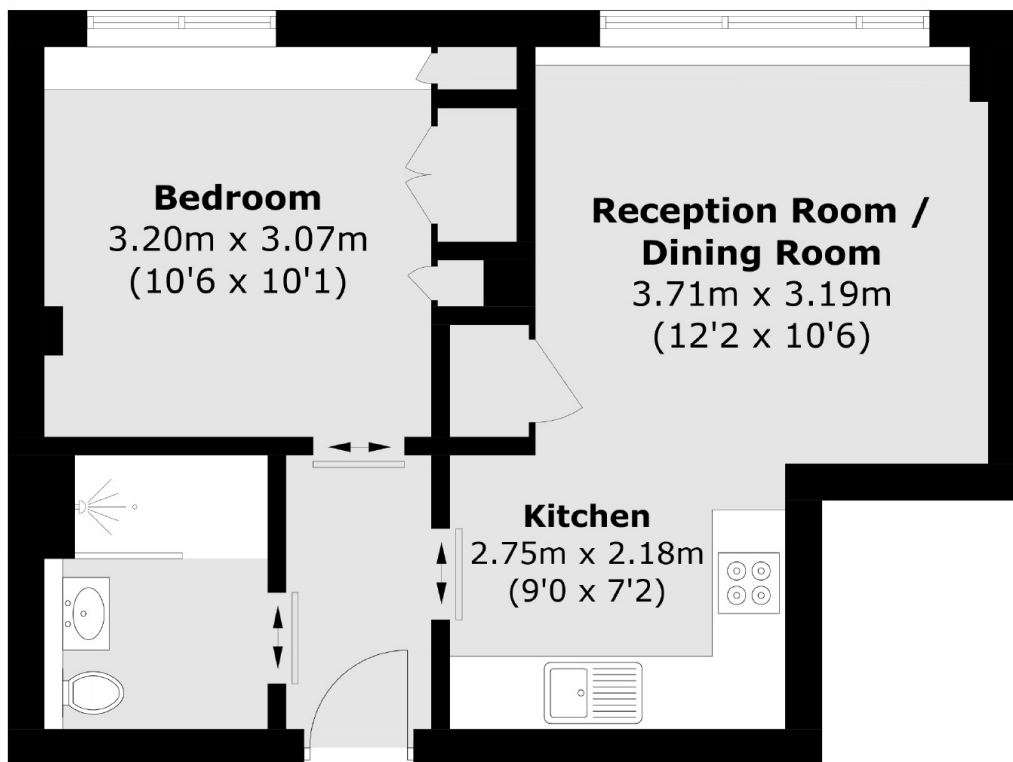

Total area (approx.): 39.8 sq. m (428.4 sq. ft)