



The Vale, NW11

£756 Per week

A Spacious four bedroom house to rent in the heart of Golders Green. The property benefits from a modern living space, separate fitted kitchen with integrated appliances, four double bedrooms, modern bathroom with separate shower cubicle, double glazed windows, great storage space and a large private garden.

The property is ideally located with easy access to the shops, restaurants, supermarkets and underground of Golders Green within a short walk (approx 10 minutes) making it an ideal distance for commuters.

Also nearby are excellent connecting major roads such as the A406, A41, M1, M25 and more. There are also numerous brilliant schools nearby for children / teenagers. UCL & ESCP Universities are easily accessible from this location also.

Features

- Four bedroom house
- One Reception
- One Bathroom
- Two WCs
- Private garden
- Parking

The Vale, London, NW11

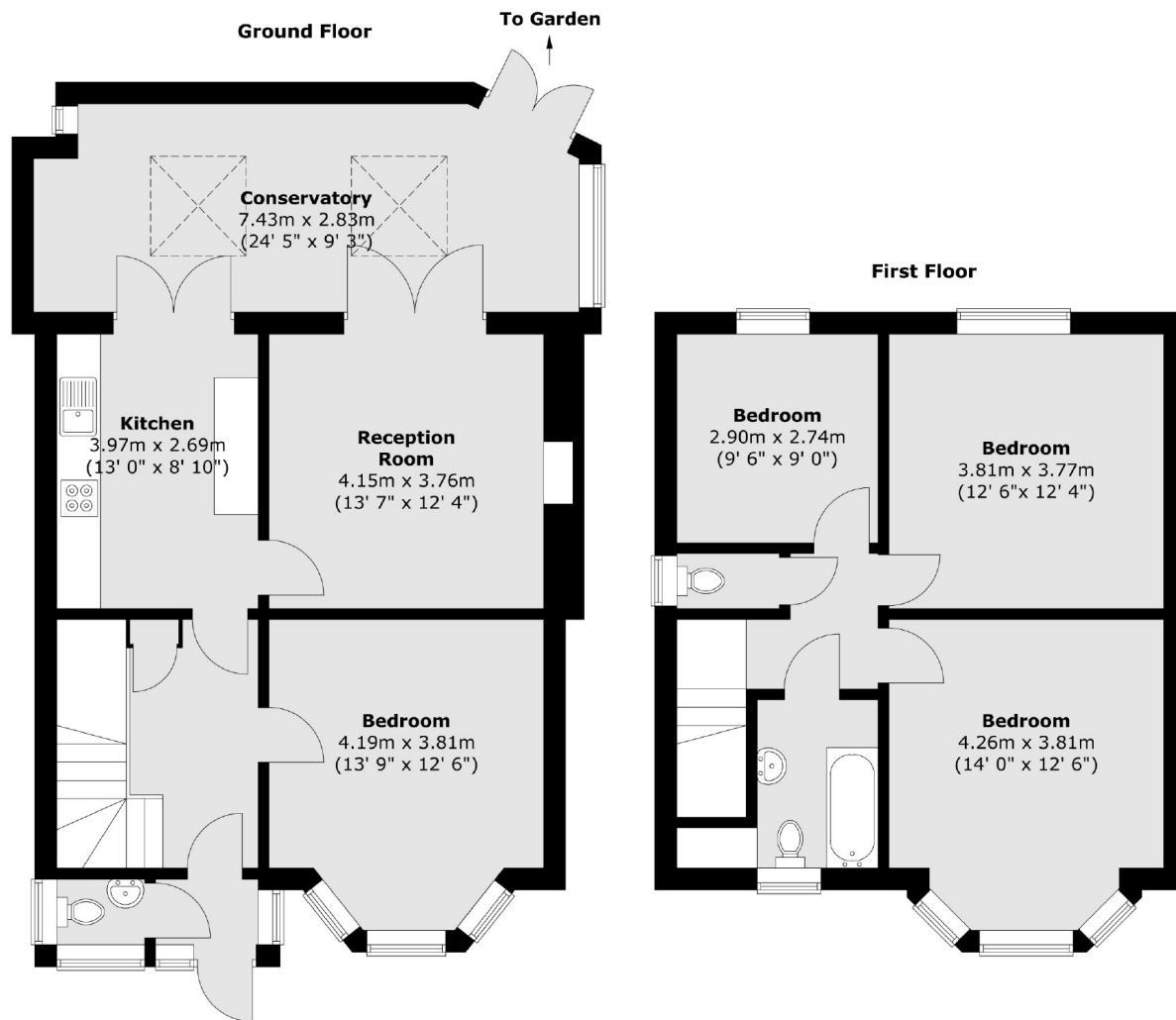

Total area (approx.) : 104.7 sq. m (1127 sq. ft)
Total conservatory area (approx.) : 21.8 sq. m (235 sq. ft)