



Maygrove Road, NW6

£553 Per week

A stunning one bedroom apartment in a new development with a gym. The property has an open plan kitchen reception, a large double bedroom and a terrace running along the back of the apartment. Perfect for a single professional or couple.

Maygrove Road is located between West End Lane and Kilburn High Road. West Hampstead Thameslink, Overground and Jubilee Line is just over quarter of a mile and there is a large selection of shops, restaurants and bars on West End Lane.

Features

- One Bedroom
- Interior Designed
- Balcony
- Large Reception
- Open Plan Kitchen
- Gymnasium

Maygrove Road,
London, NW6

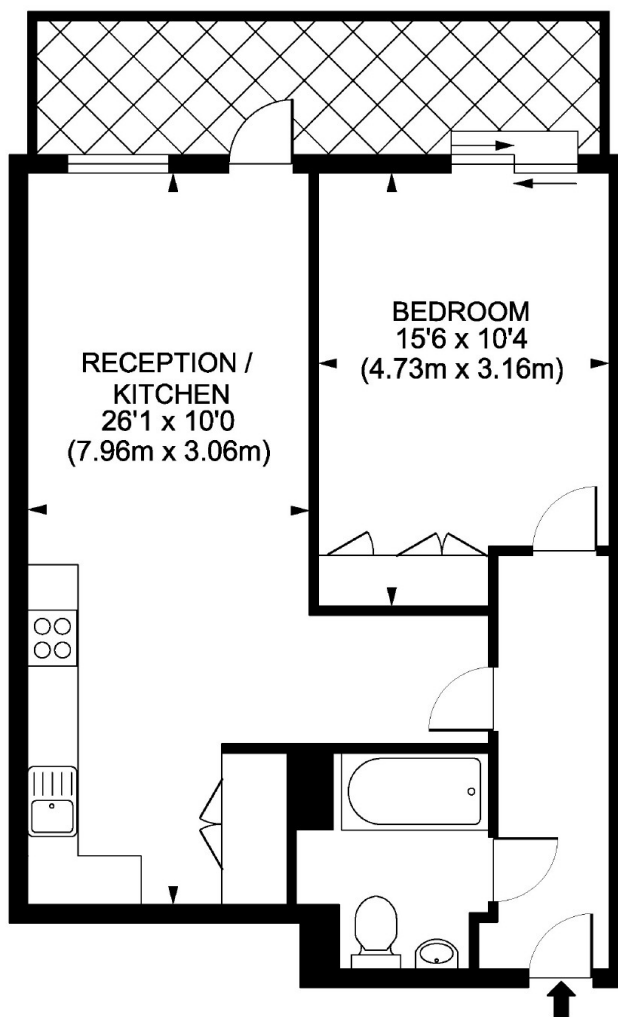

FOURTH FLOOR

Beaufort Court, London, NW6

Gross Internal Area 559 sq ft/52 sq metres

Whilst every attempt has been made to ensure the accuracy of the floorplan shown, all measurements, positioning fixtures, fittings and any other data shown are an approximate interpretation for illustrative purposes only and are not to scale. No responsibility is taken for any error, omission, miss-statement or use of data shown.

Dexters

West Hampstead Lettings
106 West End Lane
London
NW6 2LS
Lettings
020 7644 9301

Energy Rating: B. We aim to make our particulars both accurate and reliable. However they are not guaranteed; nor do they form part of an offer or contract. If you require clarification on any points then please contact us, especially if you're traveling some distance to view. Please note that appliances and heating systems have not been tested and therefore no warranties can be given as to their good working order.



dexters.co.uk