



Iverson Road, NW6

£425 Per week

A well presented two bedroom apartment with an open plan kitchen living area and a private roof terrace ideal for entertaining. Perfect for a single professional or couple.

Iverson Road is ideally located for easy access into Central London via West Hampstead Jubilee Line, Thameslink and London Overground. Local shops and amenities are nearby on West End Lane.

Features

- Period Conversion
- First Floor
- Modern
- Private Roof Terrace
- Open Plan Kitchen
- Double Glazed

Iverson Road, London, NW6

First Floor

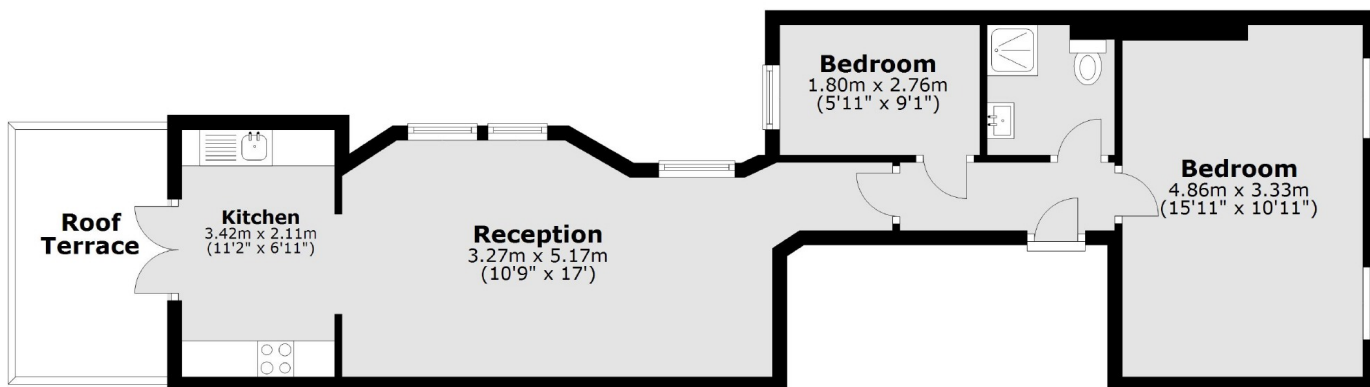

Main area: Approx. 55.2 sq. metres (594.3 sq. feet)
Plus roof terrace, approx. 7.5 sq. metres (80.8 sq. feet)