

Frank Harris & Co.



Shad Thames, SE1

£577 Per week

Two bedroom apartment with private balcony, recently refurbished bathroom and built in storage. Within a secure purpose built apartment block.

Fountain Court is located on the corner of Lafone Street and Tooley Street. Close to Shad Thames with has a choice of many bars and restaurants.

- Two Bedrooms • Second Floor • Built In Storage •
- Private Balcony • Wood Flooring • Secure Entry •

Frank Harris
— & Co. —

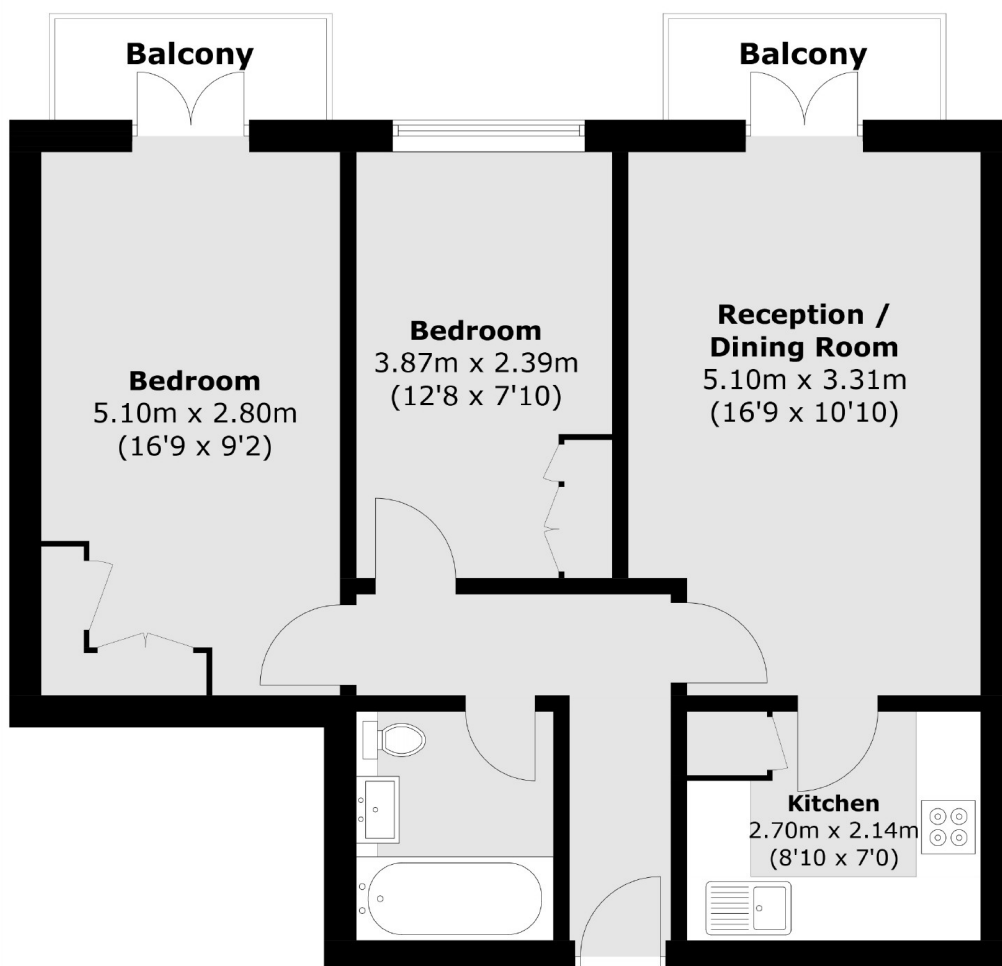

Total area (approx.): 58.8 sq. m (632.9 sq. ft)
Balcony area : 4.8 sq. m (51.6 sq. ft)

Frank Harris & Co. Tower Bridge & Bermondsey
205 Tooley Street, London,
SE1 2JX
020 7234 0880
towerbridgelettings@frankharris.co.uk

Energy Rating: C. We aim to make our particulars both accurate and reliable. However they are not guaranteed; nor do they form part of an offer or contract. If you require clarification on any points then please contact us, especially if you're traveling some distance to view. Please note that appliances and heating systems have not been tested and therefore no warranties can be given as to their good working order.

