

Frank Harris & Co.



Curlew Street, SE1

£2,200 pcm

A one bedroom property in this sought after warehouse conversion. Extending over 630 sq/ft, with a spacious open plan reception with wood floors, one bedroom, one bathroom and good storage. Parking available by separate negotiation.

Situated moments away from a selection of restaurants, bars and local amenities London Bridge has to offer as well as transport links across The City.

- One Bedroom • One Bathroom • Furnished •
- Spacious • Amazing Location • Parking Available •

Frank Harris & Co.

Second Floor

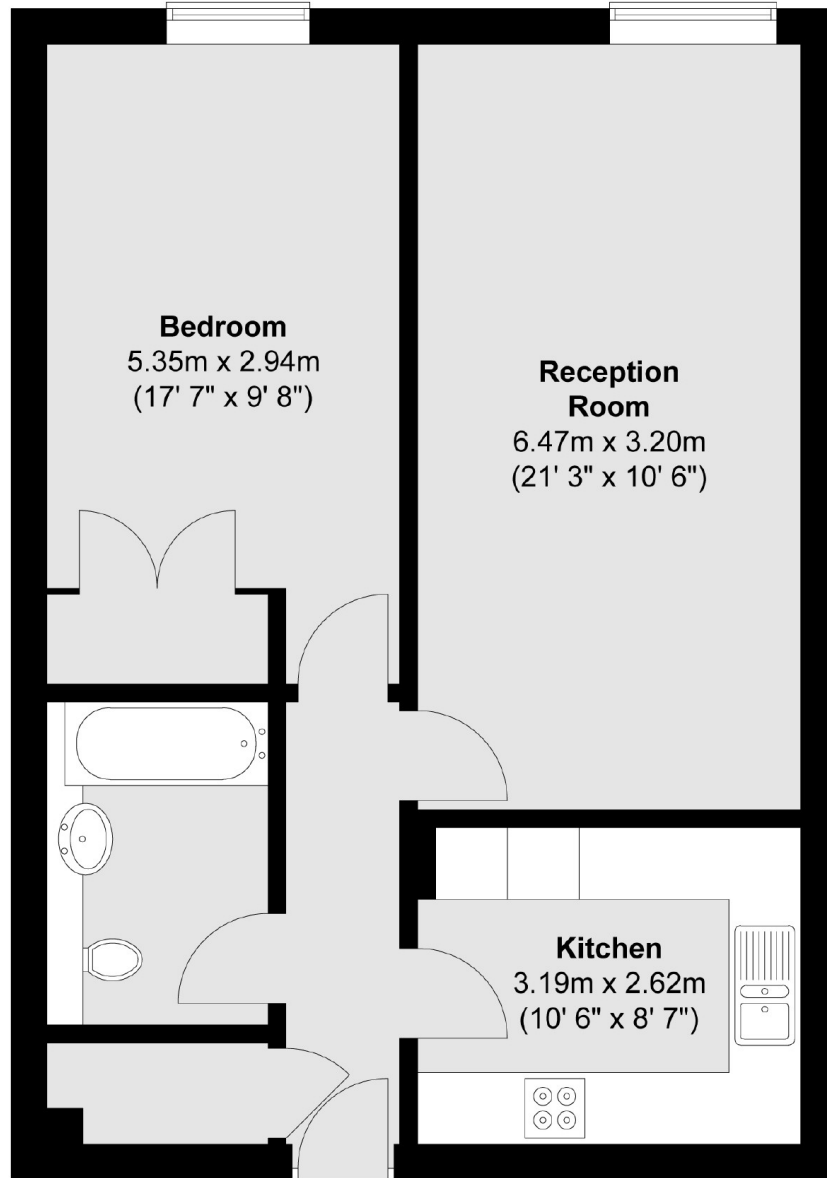

Total area (approx.) : 58.1 sq. m (625 sq. ft)

Frank Harris & Co. Tower Bridge & Bermondsey
205 Tooley Street, London,
SE1 2JX
020 7234 0880
towerbridgelettings@frankharris.co.uk

Energy Rating: . We aim to make our particulars both accurate and reliable. However they are not guaranteed; nor do they form part of an offer or contract. If you require clarification on any points then please contact us, especially if you're traveling some distance to view. Please note that appliances and heating systems have not been tested and therefore no warranties can be given as to their good working order.

