

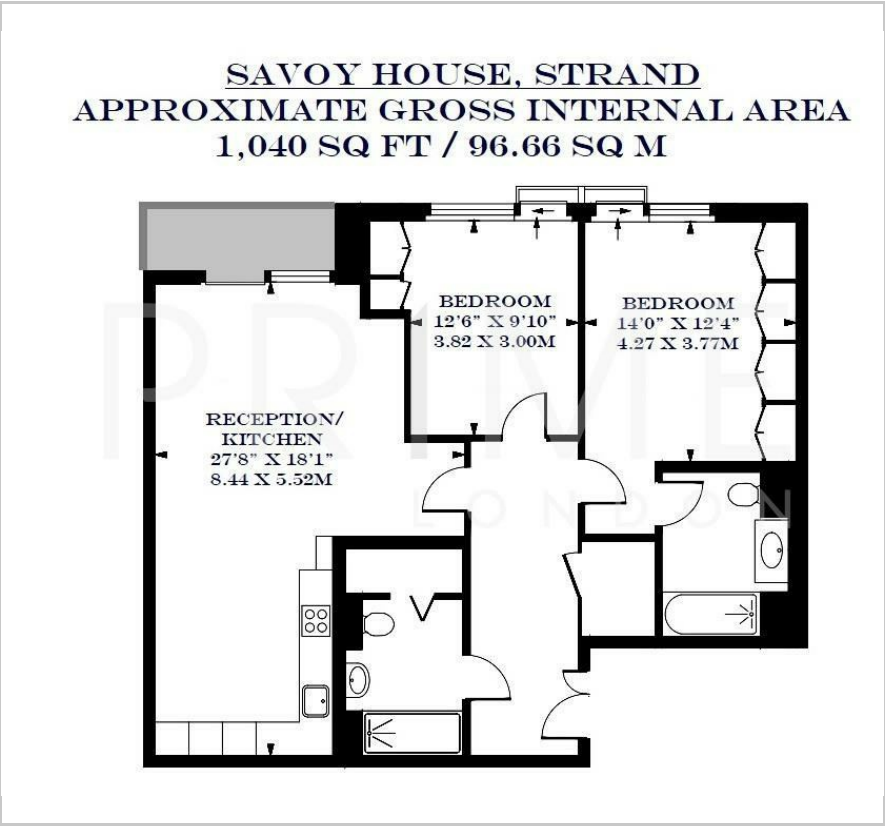



Floor Plan



Area Map



Energy Efficiency Graph



Viewing

By appointment. Contact us on 0207 052 1075 if you wish to arrange a viewing appointment for this property, or require further information.

- Premium two bedroom ■ 1,040 sq ft (96.66 sqm) apartment
- Fully furnished ■ Private residents' cinema
- State of the art gym and ■ 24 hour concierge service swimming pool/spa



This exceptional two bedroom two bathroom apartment, spanning 1,040 sq ft (96.66 sqm) and located on a higher floor within the prestigious 190 The Strand development, is now available for rent through Prime London.

This property boasts the highest specification finishes throughout and comes fully furnished. Upon entering, you'll be welcomed by a spacious entrance hall, and the large open-plan reception room seamlessly connects to a private balcony.

The dining area flows into the smart kitchen, complete with top-of-the-line Miele integrated appliances. The apartment offers two substantial double bedrooms, including the master with en suite. Comfort cooling, solid parquet wood flooring, and a convenient laundry closet further enhance the property.

This luxurious residence offers an array of top-tier amenities, including a concierge service, gym, sauna, golf simulator, and swimming pool.

190 Strand is just a short stroll from the iconic Covent Garden Piazza, providing access to a vibrant selection of shops, restaurants, bars, and theatres.

The location is exceptionally well-connected, with Temple Station (Circle & District lines) just 0.1 miles away, and Covent Garden Station (Piccadilly Line) only 0.5 miles from the development.



These particulars, whilst believed to be accurate are set out as a general outline only for guidance and do not constitute any part of an offer or contract. Intending purchasers should not rely on them as statements of representation of fact, but must satisfy themselves by inspection or otherwise as to their accuracy. No person in this firms employment has the authority to make or give any representation or warranty in respect of the property.