



**Nevill Court**

Edith Terrace, Chelsea, SW10 0TL

£575 Per Week

-  2
-  1
-  1
-  C

## Floor Plan

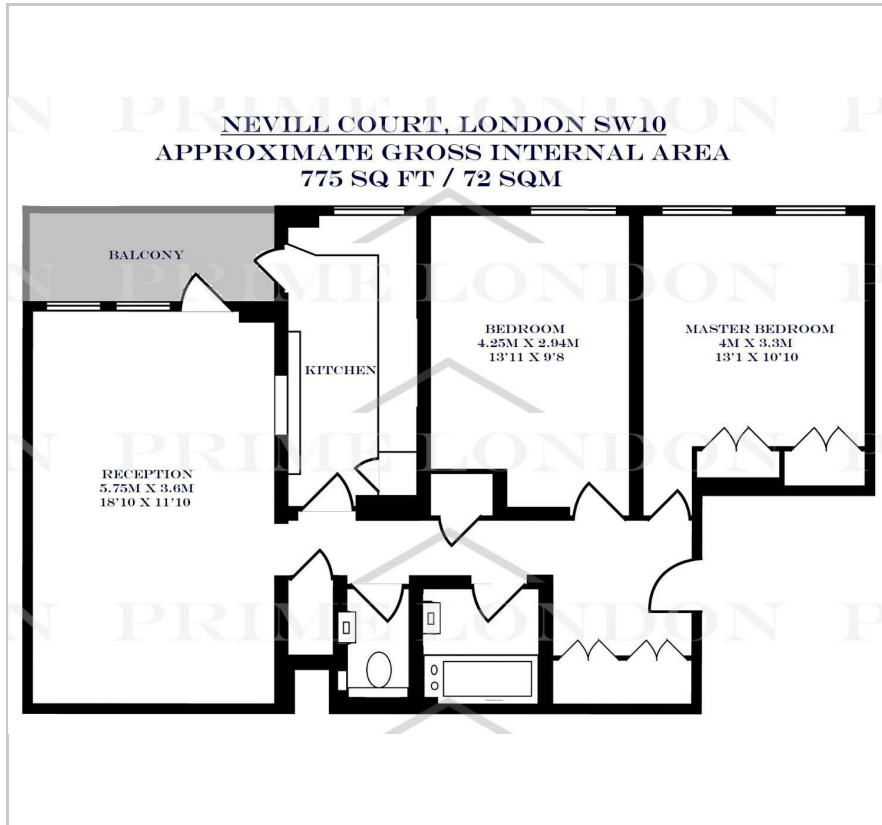

## Area Map

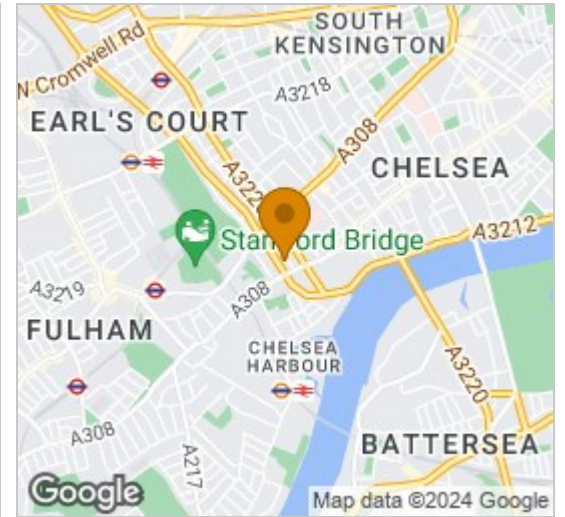

## Energy Efficiency Graph

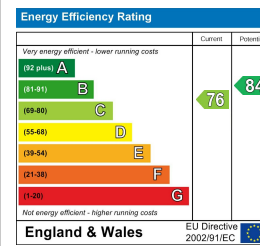

## Viewing

By appointment. Contact us on 0207 052 1075 if you wish to arrange a viewing appointment for this property, or require further information.

- 775 sq ft (72 sqm)
- Two bedroom apartment
- Unfurnished basis
- Proximity to King's Road



This 775 sq ft (72 sqm) two bedroom apartment (with lift) has been recently modernised throughout and is available exclusively through Prime London on an unfurnished basis.

Offering an abundance of space, this apartment boasts two double bedrooms and a generously proportioned reception room with balcony, along with a well-appointed kitchen.

Edith Terrace is a residential street within close proximity to King's Road and Fulham Road providing access to the local shops, bars and restaurants.

There are good transport links with Fulham Broadway underground station (District line) approximately 0.5 miles away. Earls Court underground station (District and Piccadilly lines) is approximately 0.75 miles away.

Imperial Wharf Station is approximately half a mile away, connecting to the City and Canary Wharf. In addition, there proficient bus services along both Fulham Road and King's Road.



These particulars, whilst believed to be accurate are set out as a general outline only for guidance and do not constitute any part of an offer or contract. Intending purchasers should not rely on them as statements of representation of fact, but must satisfy themselves by inspection or otherwise as to their accuracy. No person in this firm's employment has the authority to make or give any representation or warranty in respect of the property.