



Cubitt Building

Grosvenor Waterside, 10 Gatliff Road, SW1W 8QL

£692 Per Week



1



1



1



B

Floor Plan

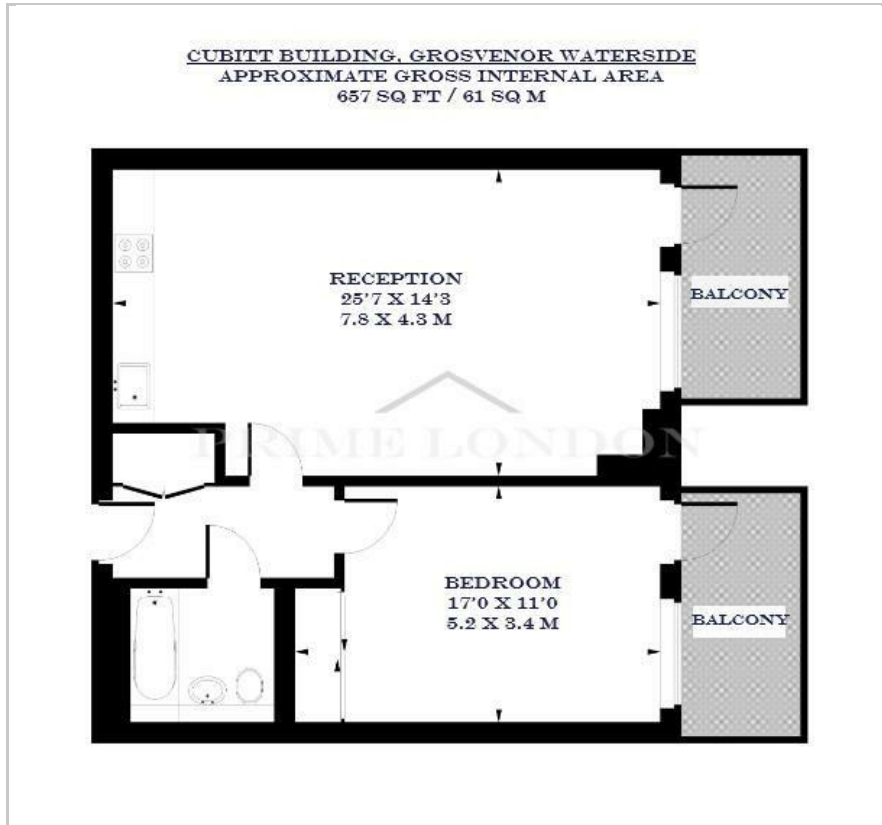

Area Map



Energy Efficiency Graph

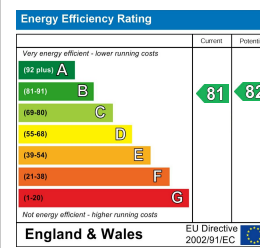

Viewing

By appointment. Contact us on 0207 052 1075 if you wish to arrange a viewing appointment for this property, or require further information.

- One bedroom apartment ▪ 657 sq ft (61 sqm)
- Featuring two private balconies
- Resident's gym and spa
- Walking distance to Battersea Power Station
- 24 hour concierge



This spacious one-bedroom apartment, located in the highly sought-after Grosvenor Waterside, is available for rent through Prime London.

At 657 sq ft (61 sqm), this is one of the largest one-bedroom units in the building. The property features a large open-plan kitchen, a generously sized bedroom with ample space, and a modern bathroom. The apartment boasts two balconies: one accessible from the living room and the other from the bedroom.

Additional benefits include access to a residents' gym, spa, and 24-hour concierge services, providing a perfect environment for modern living in one of London's most prestigious and dynamically changing areas.

Situated on the north side of the river by Chelsea Bridge, the open spaces of Battersea Park are nearby. Victoria mainline and underground station (Victoria, Circle, and District lines, Zone 1) is within close proximity. Grosvenor Waterside is just half a mile from Sloane Square underground station and within easy walking distance of the fashionable King's Road.

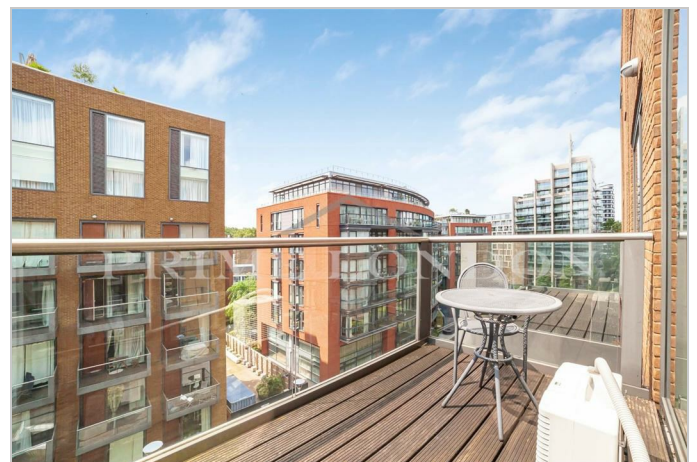

These particulars, whilst believed to be accurate are set out as a general outline only for guidance and do not constitute any part of an offer or contract. Intending purchasers should not rely on them as statements of representation of fact, but must satisfy themselves by inspection or otherwise as to their accuracy. No person in this firm's employment has the authority to make or give any representation or warranty in respect of the property.