



15 Grosvenor Crescent Mews

Belgravia, SW1X 7EU

£1,153 Per Week



Floor Plan

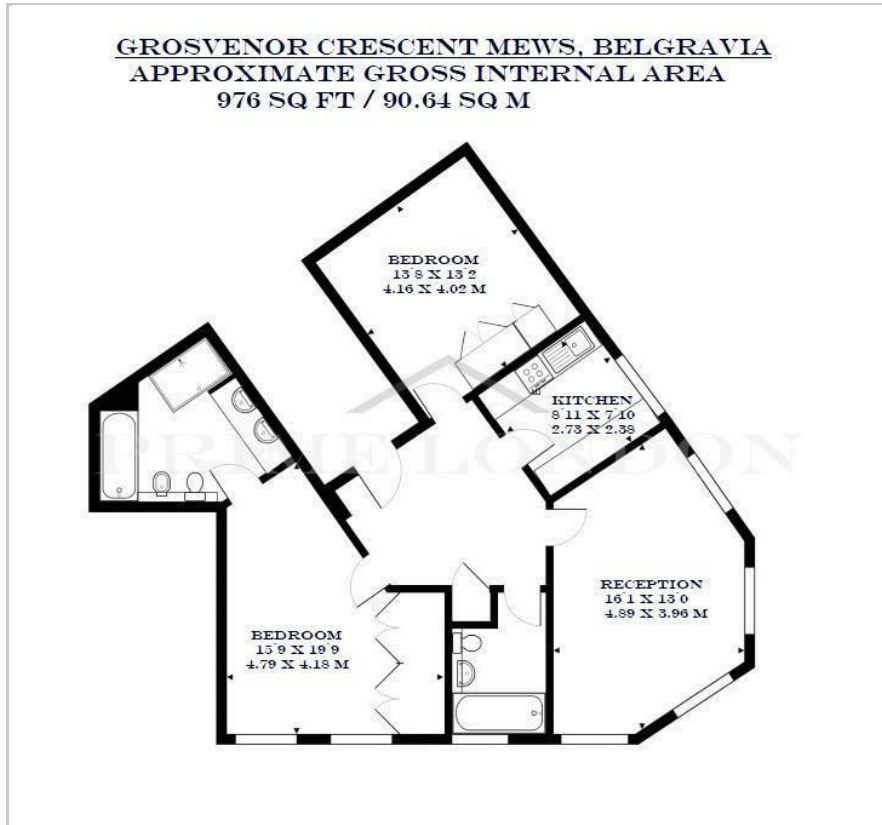

Area Map

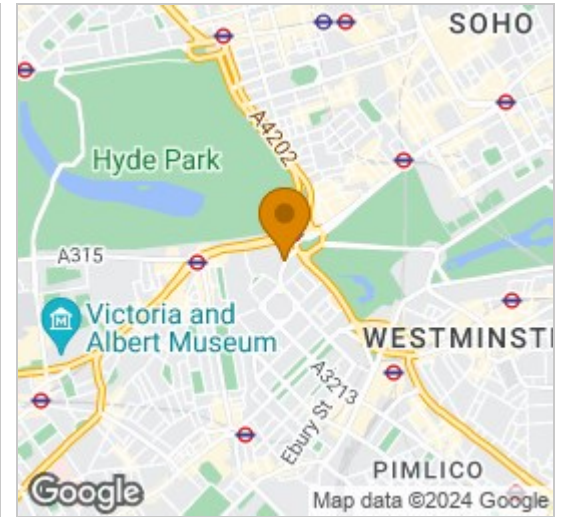

Energy Efficiency Graph



Viewing

By appointment. Contact us on 0207 052 1075 if you wish to arrange a viewing appointment for this property, or require further information.

- Large two bedroom ▪ 976 sq ft (90.64 sqm) apartment
- Private garage available
- Fully furnished
- Walk distance to Hyde Park
- Secure gated mews



This beautiful and bright two bedroom two bathroom apartment of 976 sq ft (94.64 sqm) is available fully furnished for lease through Prime London. Private parking is also available by separate negotiation.

The property features a sizeable triple aspect reception, separate kitchen, two double bedrooms with ample built in storage, and two excellent bathrooms one of which is en-suite.

Grosvenor Crescent Mews is an exclusive gated mews development, with private security at the entrance to the mews.

Located moments from Hyde Park in the heart of Belgravia. Hyde Park Corner underground station is a 4 minute walk away (0.2 miles) and Knightsbridge underground station (both serviced by the Piccadilly line) is just a 10 minute walk away (0.5 miles), as well as Victoria station (serviced by the Circle and District Lines, Victoria Line and National Rail) which is just a 15 minute walk away (0.8 miles).



These particulars, whilst believed to be accurate are set out as a general outline only for guidance and do not constitute any part of an offer or contract. Intending purchasers should not rely on them as statements of representation of fact, but must satisfy themselves by inspection or otherwise as to their accuracy. No person in this firm's employment has the authority to make or give any representation or warranty in respect of the property.