

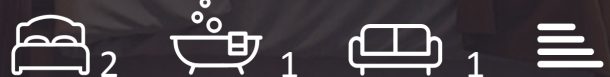

Cadence

4 Lewis Cubitt Park, King's Cross, N1C 4ED

Asking Price £1,125,000



Floor Plan

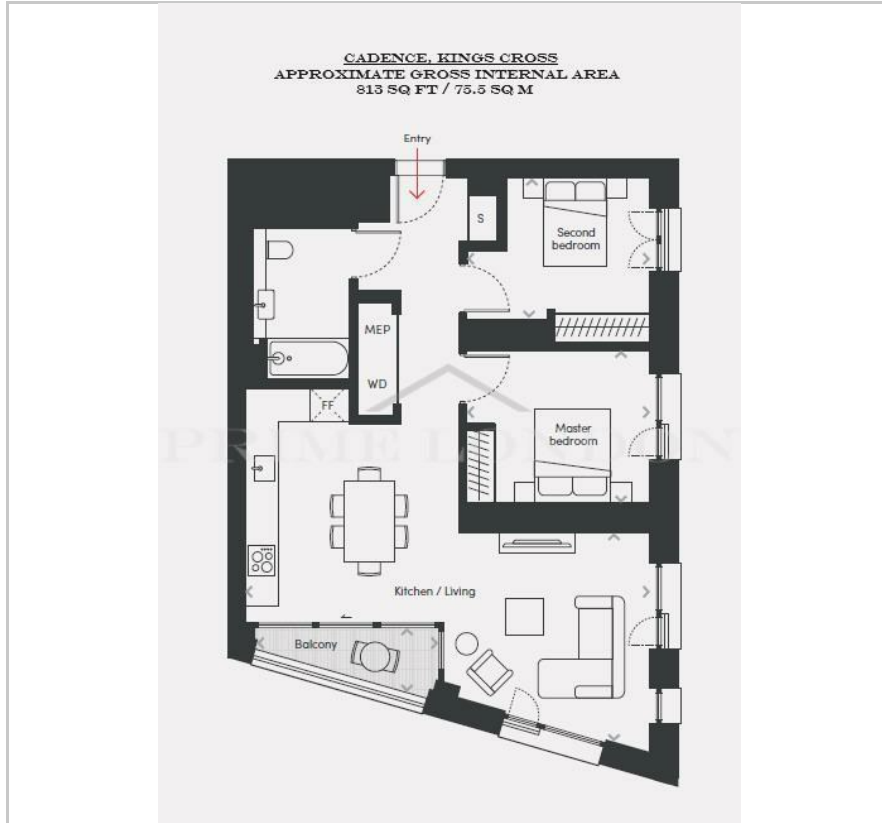

Area Map



Energy Efficiency Graph

Viewing

By appointment. Contact us on 0207 052 1075 if you wish to arrange a viewing appointment for this property, or require further information.

- 813 sq ft 75.5 sqm)
- Residents' gym and lounge
- Next to Kings Cross station
- Dual aspect reception with balcony
- 10th Floor roof terrace
- 24hr Concierge

This stunning modern 813 sq ft (75.5 sq m) two bedroom apartment in the new Cadence building, with double aspect reception and private balcony overlooking Cubitt park, is available for chain free sale through Prime London.

Finished to a high standard, the property comprises an open-plan reception room and kitchen leading to a private balcony, two spacious double bedrooms with a fitted wardrobes, and a modern bathroom.

Further benefits include 24 hour concierge service, two passenger lifts and access to a range of impressive shared spaces including a landscaped communal roof terrace and furnished residents lounge offering wonderful views over Cubitt park.

The development is enviably located moments from Granary Square and the Coal Drops Yard shopping and dining districts, with over 50 shops and restaurants. The West End and bustling high streets of Islington and Camden are all within easy reach.

There are also excellent transport links including King's Cross St Pancras which offers access to the Northern, Piccadilly, Victoria, Metropolitan, Circle and Hammersmith and City lines as well as the St. Pancras International.

*Images are computer-generated and are intended to show example finishes only.

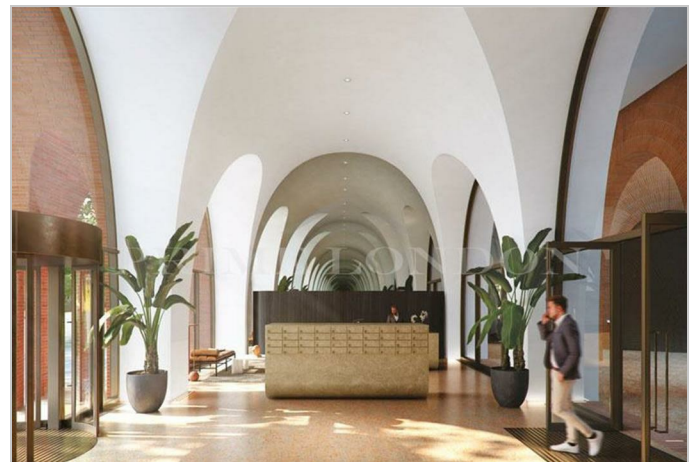

These particulars, whilst believed to be accurate are set out as a general outline only for guidance and do not constitute any part of an offer or contract. Intending purchasers should not rely on them as statements of representation of fact, but must satisfy themselves by inspection or otherwise as to their accuracy. No person in this firm's employment has the authority to make or give any representation or warranty in respect of the property.